



PRAIRIE SKY DISTRICT
COCHIN (CANADA) PIPELINE SYSTEM

EMERGENCY RESPONSE PLAN

EMERGENCY RESPONSE LINE:
1-800-360-4706

This page intentionally left blank.

COCHIN (CANADA) PIPELINE SYSTEM

TABLE OF CONTENTS

DISTRIBUTION LIST	3
REVISION RECORD	9
1.0 INTRODUCTION	11
1.1 Application.....	11
2.0 CONTACT NUMBERS	13
2.1 Pembina Emergency Numbers	13
2.2 Pembina Corporate Numbers.....	13
2.3 Prairie Sky District / Cochin (Canada) Area Contacts.....	13
2.4 Response Teams	14
2.5 Incident Command Post Locations	15
2.6 Emergency Services.....	17
2.7 Government Reporting Contacts.....	24
2.8 School Divisions	33
2.9 Mutual Aid Groups.....	34
2.10 Alberta Government Agency Mutual Aid.....	45
2.11 Saskatchewan Government Agency Mutual Aid	53
2.12 Emergency Response Support Services	71
2.13 Reception Centres.....	78
2.14 Accommodations	79
3.0 SYSTEM DESCRIPTION.....	81
3.1 The Cochin Pipeline System.....	81
3.2 Cochin (Canada) Operations Summary	83
3.3 Land Use	83
4.0 TRANSPORTED OR STORED PRODUCTS	85
4.1 Product Handling and Storage.....	85
5.0 TECHNICAL DATA.....	87
5.1 Facilities List.....	87

5.2	LVP Pipelines	88
5.3	Deactivated Pipelines.....	89
5.4	Valve Listing	90
6.0	SAFETY EQUIPMENT AND RESOURCES	93
6.1	Spill Response Equipment.....	93
6.2	Personal Protective Equipment (PPE).....	95
6.3	Radiation Safety	96
6.4	Communications/Radio Frequencies.....	96
6.5	Control Points	96
7.0	EMERGENCY SYSTEMS AND PROCEDURES	97
7.1	Incident Onset and Plan Activation	97
7.2	Incident Notifications / Reporting	97
7.3	Staging Area(s)	97
7.4	Emergency Planning Zone (EPZ)	97
7.5	Response Actions	98
7.6	Unified Command	98
8.0	STAKEHOLDERS AND MAPS	99
8.1	Area Overview Map	101
8.2	Cochin (Canada) Pipeline System Maps.....	103

Throughout this document, some details have been removed from the publicly posted version for the protection of private and/or confidential information. This may include names, phone numbers, addresses, equipment details, locations of surface installments and information collected during consultation.

DISTRIBUTION LIST

Copies of this system-specific plan work in conjunction with the *Corporate Emergency Response Plan (ERP)* and are distributed according to the following distribution list. Overall responsibility for the distribution of the plan rests with Emergency Management.

Internal Manuals				
Number	Name	Title	Location	Plan Type

For internal copies of the ERPs containing Occupant Data, where large data sets exist, a separate binder may be issued containing printed copies of the data, organized by map number. This data is to be kept in a secure location. For digital copies of the data, contact Emergency Management.

Version: 4.0

Page 4

Version: 4.0

Page 5

Version: 4.0

Page 6

Version: 4.0

Page 7

Version: 4.0

Page 8

REVISION RECORD

Emergency Management, in coordination with the appropriate Operations staff shall be responsible for the maintenance of this plan.

This Plan will be reviewed, validated, and updated regularly, or on an as-needed basis, to ensure all applicable regulations are met.

All updates shall be distributed to each individual plan holder, who will be responsible for incorporating them into their copy of the plan, as they are received.

Version	Date of Revision	Description of Revisions
1.0	June 15, 2020	Initial release
2.0	August 15, 2021	Restructured the Emergency Management Plan document. Reviewed and completed necessary revisions to content.
3.0	August 15, 2022	Reviewed and completed necessary revisions to content.
4.0	August 15, 2023	Reviewed and completed necessary revisions to content.

To request plan revisions, refer to the Revision Request Form located within the *Corporate ERP*.

This page intentionally left blank.

1.0 INTRODUCTION

This supplement is intended to work in conjunction with the Pembina Corporate Emergency Response Plan (ERP), which is based on the Incident Command System (ICS). PKM Cochin ULC is a wholly owned subsidiaries of Pembina Pipeline Corporation.

The Corporate ERP includes:

- Internal notification and activation guidelines
- Response management / organizational details
- Incident classification tools
- Responder roles and responsibilities
- Public protection measures
- Communication strategies and protocols
- Incident investigation and recovery considerations
- Training and exercise expectations
- Forms for incident documentation

It is imperative that company personnel and contractors become familiar with site or system specific related duties and responsibilities outlined in this supplemental plan. An effective response to any emergency requires preplanning and testing, to ensure all personnel are aware of their duties and that they can effectively implement them.

In preparing this supplement, the following factors were considered, as appropriate:

- Properties/characteristics and quantities of product being transported and/or stored
- Regular activities on site or within the Emergency Planning Zone (EPZ), where established
- Potential consequences to human life and health, as a result of an operational upset
- Potential consequences to the environment, as a result of an operational upset

1.1 Application

The Cochin Pipeline System traverses through portions of Canada and the United States. The Cochin (Canada) Pipeline ERP covers the Cochin Pipeline System assets/operations within Canada. Refer to the Cochin (US) Pipeline ERP for information regarding the Cochin Pipeline System assets/operations within the United States.

This page intentionally left blank.

2.0 CONTACT NUMBERS

2.1 Pembina Emergency Numbers

Name	Location	Phone
Pembina Emergency Response Line		1-800-360-4706
Emergency Management 24-Hour On-Call	Calgary	
Crisis Communications 24-Hour On-Call	Calgary	
Emergency Coordination Centre (ECC) Calgary Corporate Office, Room 34-103	Calgary	
Sherwood Park Control Centre Foreman 1	Sherwood Park	

2.2 Pembina Corporate Numbers

Name	Location	Phone
Calgary Corporate Office – Main Reception	Calgary	403-231-7500
Business Unit Leadership		
	Calgary	
	Calgary	

2.3 Prairie Sky District / Cochin (Canada) Area Contacts

Name	Cell	Office
Field Office		
Regina Field Office	-	
Wainwright Field Office	-	
Local Leadership Team		
Facility Administration		

2.4 Response Teams

Field Responders

Field Responders deliver the tactical response actions required during the incident. They are most likely to be first on scene and will deliver the actions defined by Pembina's Initial On-Site Actions. This team is usually made up of local Operations staff. If additional support is needed, the Regional Response Team and/or members of the Incident Technical Response Team can be activated to assist with Command and Control functions within the Incident Command Post (ICP).

Regional Response Team (RRT)

RRT members are trained to plan and execute response activities during an incident. They may be deployed to fill additional ICS roles within the Incident Command Post.

Activation of the RRT can be requested by the Incident Commander during the Activation Conference Call. The Cochin (Canada) System falls within the geographic area primarily supported by the East RRT.

Name	Title	Office	Cell
------	-------	--------	------

Local Regional Response Team (RRT) Members

Incident Commanders

	Supervisor, Operations		
--	------------------------	--	--

Incident Technical Response Team (ITRT)

If the Incident Commander determines the incident response warrants additional support, they may request the activation of individuals assigned to the ITRT, who may be deployed to the Incident Command Post or provide support remotely from another location.

The ITRT is a collection of Technical Specialists that provide subject matter expertise during a response. Technical Specialists may include, but are not limited to, subject matter experts (SME) from Asset Integrity, Corporate Security, Crisis Communications, Cyber Security, Environment, GIS, Human Resources, Indigenous Affairs, Land & Regulatory, Information Services, Insurance, and/or Legal.

Members of the ITRT can be requested by the Incident Commander during the Activation Conference Call.

2.5 Incident Command Post Locations

Name of Location	Address	Notes
		Primary Location
		Alternate Location
		Alternate Location
		Alternate Location

Where Pembina offices are not available or suitable for ICP locations, a local hotel or conference centre may be used. Additionally, Pembina may deploy their Command Trailer(s), where suitable to manage incident response activities.

This page intentionally left blank

**PRAIRIE SKY DISTRICT, COCHIN (CANADA) PIPELINE SYSTEM
EMERGENCY RESPONSE PLAN**

Version Date: August 2023

Version: 4.0

Name of Organization	Address	City/Town	Phone
Ambulance			
Hospitals			
Emergency Response Assistance Canada (ERAC)			

EMERGENCY RESPONSE PLAN

Version Date: August 2023

Version: 4.0

Registered STARS Site	STARS ID	Location (LSD)	Lat/Long
Air Ambulance			
STARS 24-Hour Emergency Number: 1-888-888-4567			

2.6.2 Saskatchewan Emergency Services

[illegible]

**PRAIRIE SKY DISTRICT, COCHIN (CANADA) PIPELINE SYSTEM
EMERGENCY RESPONSE PLAN**

Version Date: August 2023

Version: 4.0

Name of Organization	Address	City / Town	Phone
Police			

PRAIRIE SKY DISTRICT, COCHIN (CANADA) PIPELINE SYSTEM EMERGENCY RESPONSE PLAN

Version Date: August 2023

Version: 4.0

Name of Organization	Address	City / Town	Phone
Ambulance			
Hospitals			
Emergency Response Assistance Canada (ERAC)			

Registered STARS Site	STARS ID	Location (LSD)	Lat/Long
Air Ambulance			

2.7.2 Alberta

The Cochin Pipeline is regulated by the Canada Energy Regulator, as a courtesy the Alberta Energy Regulator (AER) can be notified through the 24-hour Energy & Environmental Response Line (1-800-222-6514).

Agency	Reporting / Notes	Location	Phone
Local Authority			

--	--	--	--

PRAIRIE SKY DISTRICT, COCHIN (CANADA) PIPELINE SYSTEM EMERGENCY RESPONSE PLAN

Version Date: August 2023

Version: 4.0

Agency	Reporting / Notes	Location	Phone
Health Authority			

PRAIRIE SKY DISTRICT, COCHIN (CANADA) PIPELINE SYSTEM EMERGENCY RESPONSE PLAN

Version Date: August 2023

Version: 4.0

Agency	Reporting / Notes	Location	Phone
Other Government Agencies			

Version Date: August 2023

Agency	Reporting / Notes	Location	Phone

The Cochin Pipeline is regulated by the Canada Energy Regulator (CER), as a courtesy the Saskatchewan Ministry of Energy and Resources can be notified through the 24-hour Incident Reporting Line (1-844-764-3637).

Pembina Pipeline Corporation Page 29

PRAIRIE SKY DISTRICT, COCHIN (CANADA) PIPELINE SYSTEM EMERGENCY RESPONSE PLAN

Version Date: August 2023

Version: 4.0

[illegible]

PRAIRIE SKY DISTRICT, COCHIN (CANADA) PIPELINE SYSTEM EMERGENCY RESPONSE PLAN

Version Date: August 2023

Version: 4.0

[illegible]

PRAIRIE SKY DISTRICT, COCHIN (CANADA) PIPELINE SYSTEM EMERGENCY RESPONSE PLAN

Version Date: August 2023

Version: 4.0

Saskatchewan Agency	Reporting / Notes	Location	Phone
Health Authority			
Other Government Agencies			

Saskatchewan Agency

Reporting / Notes

Location

Phone

2.8

School Divisions

School Division Roles and Responsibilities

EMERGENCY RESPONSE PLAN

Version Date: August 2023

Version: 4.0

[illegible]

EMERGENCY RESPONSE PLAN

Version Date: August 2023

Version: 4.0

[illegible]

[illegible]

Northeast Region Community Awareness Emergency Response (NR CAER) *continued*

Northeast Region Community Awareness Emergency Response (NR CAER) *continued*

Northeast Region Community Awareness Emergency Response (NR CAER) *continued*

Northeast Region Community Awareness Emergency Response (NR CAER) *continued*

2.9.5 Strathcona District Mutual Assistance Program (SDMAP)

Strathcona District Mutual Assistance Program (SDMAP)	
Contact	24-Hour Phone

2.9.6 Emergency Response Assistance Canada (ERAC)

Emergency Response Assistance Canada (ERAC)	
Emergency Reporting Line	ERAP Plan Reference

This page intentionally left blank.

2.10 Alberta Government Agency Mutual Aid

In addition to the standard government agency duties listed in the *Corporate ERP*, consultations were conducted with the following local agencies.

2.10.1 City of Fort Saskatchewan

Local Authority	Main	Contact Name / Title	24-Hour
City of Fort Saskatchewan			
Roles and Responsibilities			
Consulted with:		Consultation Date:	Last verification was with on December 1, 2021

2.10.2 Beaver County

Local Authority	Main	Contact Name / Title	24-Hour
Beaver County (Beaver Emergency Services Commission)			
Roles and Responsibilities			
Municipal Emergency Operations Centre (MEOC)			
Consulted with:		Consultation Date:	June 7, 2023

2.10.3 County of Minburn

Local Authority	Main	Contact Name / Title	24-Hour
County of Minburn			
Roles and Responsibilities			
Municipal Emergency Operations Centre (MEOC)			
Consulted with:		Consultation Date:	Last verification was with on July 20, 2022

2.10.4 Lamont County

Local Authority	Main	Contact Name / Title	24-Hour
Lamont County			
Roles and Responsibilities			
Municipal Emergency Operations Centre (MEOC)			
Consulted with:		Consultation Date:	March 22, 2023

2.10.5 M.D. of Provost

Local Authority	Main	Contact Name / Title	24-Hour
M.D. of Provost No. 52			
Roles and Responsibilities			
Municipal Emergency Operations Centre (MEOC)			
Consulted with:		Consultation Date:	June 6, 2023

2.10.6 M.D. of Wainwright

Local Authority	Main	Contact Name / Title	24-Hour
M.D. of Wainwright No. 61			
Roles and Responsibilities			

Local Authority	Main	Contact Name / Title	24-Hour
M.D. of Wainwright No. 61			
Municipal Emergency Operations Centre (MEOC)			
Consulted with:		Consultation Date:	

2.10.7 Strathcona County

Local Authority	Main	Contact Name / Title	24-Hour
Strathcona County			
Roles and Responsibilities			
Municipal Emergency Operations Centre (MEOC)			
Consulted with:		Consultation Date:	February 17, 2023

Health Authority		24-Hour	
Alberta Health Services - Z3 Central			
Environmental Public Health Roles and Responsibilities			
Consulted with:		Consultation Date:	March 10, 2023

2.10.9 Alberta Health Services (AHS) – Zone 4 Edmonton

Health Authority		24-Hour	
Alberta Health Services - Z4 Edmonton			
Environmental Public Health Roles and Responsibilities			
Consulted with:		Consultation Date:	February 21, 2023

2.11 Saskatchewan Government Agency Mutual Aid

2.11.1 City of Regina

Local Authority	Main	Contact Name / Title	24-Hour
City of Regina			
Roles and Responsibilities			
Municipal Emergency Operations Centre (MEOC)			
Consulted with:		Consultation Date:	August 8, 2023

Note: The City of Regina intersects with a discontinued segment of the Cochin (Canada) Pipeline.

2.11.2 R.M. of Argyle No. 1

Local Authority	Main	Contact Name / Title	24-Hour
R.M. of Argyle No. 1			
Roles and Responsibilities			
Consulted with:		Consultation Date:	Last verification was with on July 13, 2022

2.11.3 R.M. of Bratt's Lake No. 129

Local Authority	Main	Contact Name / Title	24-Hour
R.M. of Bratt's Lake No. 129			
Roles and Responsibilities			
Consulted with:		Consultation Date:	June 14, 2023

2.11.4 R.M. of Brock No. 64

Local Authority	Main	Contact Name / Title	24-Hour
R.M. of Brock No. 64			
Roles and Responsibilities			
Consulted with:		Consultation Date:	

2.11.5 R.M. of Browning No. 34

Local Authority	Main	Contact Name / Title	24-Hour
R.M. of Browning No. 34			
Roles and Responsibilities			
Consulted with:		Consultation Date:	June 15, 2023

2.11.6 R.M. of Craik No. 222

Local Authority	Main	Contact Name / Title	24-Hour
R.M. of Craik No. 222			
Roles and Responsibilities			
Municipal Emergency Operations Centre (MEOC)			
Consulted with:		Consultation Date:	June 14, 2023

2.11.7 R.M. of Dufferin No. 190

Local Authority	Main	Contact Name / Title	24-Hour
R.M. of Dufferin No. 190			
Roles and Responsibilities			
Municipal Emergency Operations Centre (MEOC)			
Consulted with:		Consultation Date:	June 16, 2023

2.11.8 R.M. of Enniskillen No. 3

Local Authority	Main	Contact Name / Title	24-Hour
R.M. of Enniskillen No. 3			
Roles and Responsibilities			
Municipal Emergency Operations Centre (MEOC)			
Consulted with:		Consultation Date:	Last verification was with on July 4, 2022

2.11.9 R.M. of Eye Hill No. 382

Local Authority	Main	Contact Name / Title	24-Hour
R.M. of Eye Hill No. 382			
Roles and Responsibilities			
Consulted with:		Consultation Date:	June 27, 2023

2.11.10 R.M. of Fertile Valley No. 285

Local Authority	Main	Contact Name / Title	24-Hour
R.M. of Fertile Valley No. 285			
Roles and Responsibilities			
Municipal Emergency Operations Centre (MEOC)			
Consulted with:		Consultation Date:	July 31, 2023

2.11.11 R.M. of Fillmore No. 96

Local Authority	Main	Contact Name / Title	24-Hour
R.M. of Fillmore No. 96			
Roles and Responsibilities			
Municipal Emergency Operations Centre (MEOC)			
Consulted with:		Consultation Date:	June 6, 2023

2.11.12 R.M. of Francis No.127

Local Authority	Main	Contact Name / Title	24-Hour
R.M. of Francis No.127			
Roles and Responsibilities			
Consulted with:		Consultation Date:	June 21, 2023

2.11.13 R.M. of Grass Lake No. 381

Local Authority	Main	Contact Name / Title	24-Hour
R.M. of Grass Lake No. 381			
Roles and Responsibilities			
Consulted with:		Consultation Date:	July 25, 2023

2.11.14 R.M. of Griffin No. 66

Local Authority	Main	Contact Name / Title	24-Hour
R.M. of Griffin No. 66			
Roles and Responsibilities			
Municipal Emergency Operations Centre (MEOC)			
Consulted with:		Consultation Date:	June 22, 2023

2.11.15 R.M. of Huron No. 223

Local Authority	Main	Contact Name / Title	24-Hour
R.M. of Huron No. 223			
Roles and Responsibilities			
Consulted with:		Consultation Date:	June 19, 2023

2.11.16 R.M. of Lajord No. 128

Local Authority	Main	Contact Name / Title	24-Hour
R.M. of Lajord No. 128			
Roles and Responsibilities			
Consulted with:		Consultation Date:	June 20, 2023

2.11.17 R.M. of Loreburn No. 254

Local Authority	Main	Contact Name / Title	24-Hour
R.M. of Loreburn No. 254			
Roles and Responsibilities			
Municipal Emergency Operations Centre (MEOC)			
Consulted with:		Consultation Date:	June 16, 2023

2.11.18 R.M. of Mariposa No. 350

Local Authority	Main	Contact Name / Title	24-Hour
R.M. of Mariposa No. 350			
Roles and Responsibilities			
Municipal Emergency Operations Centre (MEOC)			
Consulted with:		Consultation Date:	June 27, 2023

2.11.19 R.M. of Milden No. 286

Local Authority	Main	Contact Name / Title	24-Hour
R.M. of Milden No. 286			
Roles and Responsibilities			
Municipal Emergency Operations Centre (MEOC)			
Consulted with:		Consultation Date:	June 15, 2023

2.11.20 R.M. of Moose Creek No. 33

Local Authority	Main	Contact Name / Title	24-Hour
R.M. of Moose Creek No. 33			
Roles and Responsibilities			
Consulted with:		Consultation Date:	June 16, 2023

2.11.21 R.M. of Mount Pleasant No. 2 / Town of Carnduff

Local Authority	Main	Contact Name / Title	24-Hour
R.M. of Mount Pleasant No. 2 / Town of Carnduff			
Roles and Responsibilities			
Municipal Emergency Operations Centre (MEOC)			
Consulted with:		Consultation Date:	June 19, 2023

2.11.22 R.M. of Mountain View No. 318

Local Authority	Main	Contact Name / Title	24-Hour
R.M. of Mountain View No. 318			
Roles and Responsibilities			
Municipal Emergency Operations Centre (MEOC)			
Consulted with:		Consultation Date:	June 26, 2023

2.11.23 R.M. of Oakdale No. 320

Local Authority	Main	Contact Name / Title	24-Hour
R.M. of Oakdale No. 320			
Roles and Responsibilities			
Municipal Emergency Operations Centre (MEOC)			
Consulted with:		Consultation Date:	June 16, 2023

2.11.24 R.M. of Pense No. 160

Local Authority	Main	Contact Name / Title	24-Hour
R.M. of Pense No. 160			
Roles and Responsibilities			
Consulted with:		Consultation Date:	August 30, 2023

2.11.25 R.M. of Pleasant Valley No. 288

Local Authority	Main	Contact Name / Title	24-Hour
R.M. of Pleasant Valley No. 288			
Roles and Responsibilities			
Consulted with:		Consultation Date:	June 19, 2023

2.11.26 R.M. of Progress No. 351

Local Authority	Main	Contact Name / Title	24-Hour
R.M. of Progress No. 351			
Roles and Responsibilities			
Municipal Emergency Operations Centre (MEOC)			
Consulted with:		Consultation Date:	June 29, 2023

2.11.27 R.M. of Sherwood No. 159

Local Authority	Main	Contact Name / Title	24-Hour
R.M. of Sherwood No. 159			
Roles and Responsibilities			
Municipal Emergency Operations Centre (MEOC)			
Consulted with:		Consultation Date:	Last verification was with on June 30, 2022

2.11.28 R.M. of St. Andrews No. 287

Local Authority	Main	Contact Name / Title	24-Hour
R.M. of St. Andrews No. 287 (includes Town of Rosetown)			
Roles and Responsibilities			
Municipal Emergency Operations Centre (MEOC)			
Consulted with:		Consultation Date:	Last verification was with on June 30, 2022

2.11.29 R.M. of Tecumseh No. 65

Local Authority	Main	Contact Name / Title	24-Hour
R.M. of Tecumseh No. 65 / Town of Stoughton			
Roles and Responsibilities			
Municipal Emergency Operations Centre (MEOC)			
Consulted with:		Consultation Date:	August 3, 2023

2.11.30 R.M. of Wellington No. 97

Local Authority	Main	Contact Name / Title	24-Hour
R.M. of Wellington No. 97			
Roles and Responsibilities			
Municipal Emergency Operations Centre (MEOC)			
Consulted with:		Consultation Date:	June 22, 2023

2.11.31 R.M. of Willner No. 253

Local Authority	Main	Contact Name / Title	24-Hour
R.M. of Willner No. 253			
Roles and Responsibilities			
Municipal Emergency Operations Centre (MEOC)			
Consulted with:		Consultation Date:	June 15, 2023

2.11.32 R.M. of Winslow No. 319

Local Authority	Main	Contact Name / Title	24-Hour
R.M. of Winslow No. 319			
Roles and Responsibilities			
Municipal Emergency Operations Centre (MEOC)			
Consulted with:		Consultation Date:	June 26, 2023

2.11.33 Town of Kerrobert

Local Authority	Main	Contact Name / Title	24-Hour
Town of Kerrobert			
Roles and Responsibilities			
Municipal Emergency Operations Centre (MEOC)			
Consulted with:		Consultation Date:	June 15, 2023

2.11.34 Village of Dodsland

Local Authority	Main	Contact Name / Title	24-Hour
Village of Dodsland			
Roles and Responsibilities			
Consulted with:		Consultation Date:	June 27, 2023

2.11.35 Saskatchewan Health Authority

Local Authority	Main	Contact Name / Title	24-Hour
Saskatchewan Health Authority			
Environmental Public Health Roles and Responsibilities			
Consulted with:		Consultation Date:	June 20, 2023

Company Name	Equipment / Services	Location	Main	24-Hour
Communications, continued				
Construction and General Contractor				
Emergency Management Consultant				

Version Date: August 2023

Company Name	Equipment / Services	Location	Main	24-Hour
Environmental Contractors				
Industrial Fire Fighting				
Line Locating				

Company Name	Equipment / Services	Location	Main	24-Hour
Pipeline Maintenance				
Portable Flare Systems				
Security Guards				
Trucking and Transportation				

Company Name	Equipment / Services	Location	Main	24-Hour
Wildlife Management				
Wildlife Rehabilitation				

PRAIRIE SKY DISTRICT, COCHIN (CANADA) PIPELINE SYSTEM EMERGENCY RESPONSE PLAN

Version Date: August 2023

Version: 4.0

2.12.2 Saskatchewan

[illegible]

Company Name	Equipment / Services	Location	Main	24-Hour
Emergency Management Support				
Industrial Fire Fighting				
Line Locating				
Security Guards				
Wildlife Management Contractors				
Wildlife Rehabilitation				

2.13 Reception Centres

A Reception Centre will be activated when members of the public within the EPZ are displaced due to an emergency. To ensure a coordinated response, the Reception Centre(s) is ideally activated by the Local Authority in coordination with Pembina.

Local Authorities have identified the following potential Reception Centre locations.

Name of Centre	Address	Selected by
Alberta		
Saskatchewan		

2.14 Accommodations

Hotels/Motels may be required for response staff or to temporarily house local residents who are displaced due to the emergency.

Name of Centre	Address	Amenities	Contact	Phone

This page intentionally left blank.

3.0 SYSTEM DESCRIPTION

3.1 The Cochin Pipeline System

The Cochin Pipeline System traverses through the Provinces of Alberta and Saskatchewan within Canada and continues through multiple states within the United States. The Cochin Pipeline System is 2839 km (~1764 miles) long and transports condensate.

The Cochin Pipeline System receives condensate from pipelines near _____ in Illinois, US and _____ in North Dakota, US. Product is delivered to Fort Saskatchewan, AB, where the Cochin (Canada) Pipeline System connects with several terminals and pipelines that are used to store and deliver condensate to oil sands production sites within Alberta.

Pipeline Details	Length 2839 km (1,764 miles) Cochin (Canada) Pipeline System – 1001 km (622 miles) Cochin (US) Pipeline System – 1838 km (1142 miles)															
Monitoring and Control																
Maintenance Zone																
Emergency Planning Zone (EPZ)	The Cochin Pipeline System EPZ is 200 m. To calculate the EPZ, several assumptions were used including, but not limited to, volume released, size of pool, properties of the product, and radiant heat load.															
Worst Case Discharge Volumes (WCDV)	WCDVs have been calculated along Cochin Pipeline using available pipeline information including maximum flow rate, maximum release discovery time, maximum shut down time, line length between block valves, and total line fill volume.															
	<table><tr><th colspan="4">WCDV Pipeline Release</th></tr><tr><th>Maintenance Zone</th><th>Scenario</th><th>Potential Oil Group</th><th>Planning Volume</th></tr><tr><td colspan="4"></td></tr></table>				WCDV Pipeline Release				Maintenance Zone	Scenario	Potential Oil Group	Planning Volume				
	WCDV Pipeline Release															
Maintenance Zone	Scenario	Potential Oil Group	Planning Volume													
	Calculations assume a full line bore rupture scenario.															

The Cochin Pipeline System Overview Map (Canada and Unites States)



3.2 Cochin (Canada) Operations Summary

The Cochin (Canada) Pipeline System is a 1001 km (622 miles) low vapor pressure (LVP) pipeline traversing from Fort Saskatchewan, AB through the Province of Saskatchewan, to the Canada / United States border. This pipeline transports condensate at approximately 1000 PSI with a maximum of 1400 PSI.

The Canadian portion of the Cochin Pipeline System may also be referred to as the _____ and is regulated by the Canadian Energy Regulator (CER).

There are no tank terminal storage facilities, or breakout tanks along the Cochin Pipeline System within Canada.

3.3 Land Use

The Cochin (Canada) Pipeline System traverses through some industrial areas; however, the majority of the pipeline route predominantly runs through rural areas with limited population density within Alberta and Saskatchewan. The pipeline system crosses various highways, major roads, rail crossings, and rivers/watercourses along the pipeline route.

Detailed stakeholder and land use information is listed within the Stakeholders and Maps section of this plan.

This page intentionally left blank.

4.0 TRANSPORTED OR STORED PRODUCTS

4.1 Product Handling and Storage

General product characteristics of products transported or stored are listed below. For a complete Safety Data Sheet (SDS) including first aid treatment, firefighting measures, and initial response to an accidental release refer to Pembina's SDS database on Pembina's internal intranet site, *The Pipeline*.

The condensate product transported by the Cochin Pipeline System is clear and colorless. Due to the volatility of the product, response tactics would vary from a typical oil release.

Containment methods (i.e., control points) should be installed ahead of the leading edge of the released fluids to prevent further flow driven product migration allowing time for the product to volatilize and disassociate within the water column. Air monitoring will be required to ensure it is safe for responders to remain at or return to the location.

Product	Hazards	Handling and Storage
Condensate	<ul style="list-style-type: none">Extremely flammable liquid and vapourMost vapours are heavier than air and spread along the ground and collect in low or confined areasVapours may travel to the source of ignition and flash back	<ul style="list-style-type: none">Wear protective gloves, protective clothing and eye protectionEnsure adequate ventilationDo not breathe mist, vapours or sprayKeep away from heat, sparks, open flames, and hot surfacesStore in well-ventilated areaKeep container tightly closedKeep container cool

This page intentionally left blank.

5.0 TECHNICAL DATA

5.1 Facilities List

Licensee	Map	Name	Facility ID	Location	Latitude (Decimal Degrees)	Longitude (Decimal Degrees)	Facility Type	Status	EPZ (m)
PEMBINA OPERATING									
PEMBINA PIPELINE CORP.	1						MS	O	200
PEMBINA PIPELINE CORP.	4						PS	O	200
PEMBINA PIPELINE CORP.	7						PS	O	200
PEMBINA PIPELINE CORP.	10 & 11						PS	O	200
PEMBINA PIPELINE CORP.	14						PS	O	200
PEMBINA PIPELINE CORP.	18						PS	O	200
PEMBINA PIPELINE CORP.	21 & 22						PS	O	200
PEMBINA PIPELINE CORP.	25						PS	O	200
PEMBINA PIPELINE CORP.	29						PS	O	200
PEMBINA PIPELINE CORP.	32 & 33						PS	O	200
PEMBINA PIPELINE CORP.	36						PS	O	200

LEGEND

Facility: MS=Meter Station PS=Pump Station
Status: O=Operating
Other: EPZ=Emergency Planning Zone

5.2 LVP Pipelines

License No.	Line No.	Map	Pipeline Name	From	To	Segment Length (m)	Internal Status	Internal Sub	OD (mm)	Wall (mm)	Licensed Pressure (kPa)	H ₂ S (%)	Licensee/Operator	Water Cross	Assigned EPZ (m)
PEMBINA PIPELINES OPERATED BY THE PRAIRIE SKY DISTRICT															
80015	1	1 to 7				181200	O	LV	323.9	5.8		0.00	PKM COCHIN ULC	-	200
80015	5	7 to 11				183900	O	LV	323.9	5.8		0.00	PKM COCHIN ULC	R	200
80015	1	11 to 14					O	LV	323.9	5.8		0.00	PKM COCHIN ULC	R	200
80015	5	14 to 22				192300	O	LV	323.9	5.8		0.00	PKM COCHIN ULC	R	200
80015	5	22 to 29				191800	O	LV	323.9	5.8		0.00	PKM COCHIN ULC	R	200
80015	5	20 to 36				190900	O	LV	323.9	5.8		0.00	PKM COCHIN ULC	R	200
80015	5	36 to 38				56000	O	LV	323.9	5.8		0.00	PKM COCHIN ULC	R	200

LEGEND

Water Cross: C=River Crossing

Facility: GP=Gas Plant PL=Pipeline PS=Pump Station

Substance: LV=Low Vapour

Status: O=Operating

Other EPZ=Emergency Planning Zone OD=Outside Diameter Wall=Wall Thickness

5.3 Deactivated Pipelines

License No.	Line No.	Map	Pipeline Name	From	To	Segment Length (m)	Internal Status	Internal Sub	OD (mm)	Wall (mm)	Licensed Pressure (kPa)	H ₂ S (%)	Licensee/Operator	Water Cross	Assigned EPZ (m)
PEMBINA PIPELINES OPERATED BY THE PRAIRIE SKY DISTRICT															
80015	2	4				100	V	LV	254.0	5.8		0.00	PKM COCHIN ULC	-	0
80015	3	7				400	V	LV	254.0	5.8		0.00	PKM COCHIN ULC	-	0
AO-001-XO-K077-016-2016	16	27				530	V	MG	273.1	9.3		0.00	PKM COCHIN ULC	-	0
AO-001-XO-K077-016-2016	12	27				420	V	MG	273.1	9.3		0.00	PKM COCHIN ULC	-	0
AO-001-XO-K077-016-2016	17	27				530	V	MG	273.1	9.3		0.00	PKM COCHIN ULC	-	0
AO-001-XO-K077-016-2016	11	27				420	V	MG	273.1	9.3		0.00	PKM COCHIN ULC	-	0
MO-013-2017	8	27				7300	V	MG	273.1	0.0		0.00	PKM COCHIN ULC	-	0
MO-013-2017	10	27				250	V	MG	273.1	0.0		0.00	PKM COCHIN ULC	-	0
MO-013-2017	4	27				0	V	MG	273.1	0.0		0.00	PKM COCHIN ULC	-	0
MO-013-2017	9	27				7300	V	MG	273.1	0.0		0.00	PKM COCHIN ULC	-	0
MO-013-2017	7	27				7300	V	MG	273.1	0.0		0.00	PKM COCHIN ULC	-	0
MO-013-2017	6	27				7300	V	MG	273.1	0.0		0.00	PKM COCHIN ULC	-	0

LEGEND

Facility: BE=Blind End PL=Pipeline

Substance: LV=Low Vapour MG=Miscellaneous Gases

Status: V=Deactivated

Other EPZ=Emergency Planning Zone OD=Outside Diameter Wall=Wall Thickness

5.4 Valve Listing

Pipeline Name	Route ID	Map	Valve Name	Valve ID	Valve Type	Location	Latitude (Decimal Degrees)	Longitude (Decimal Degrees)
COACHIN PIPELINE SYSTEM								
NPS 12 FABYAN TO FORT SASKATCHEWAN	47755	1			UNKNOWN			
NPS 12 FABYAN TO FORT SASKATCHEWAN	47755	1			UNKNOWN			
NPS 12 FABYAN TO FORT SASKATCHEWAN	47755	1			GATE			
NPS 12 FABYAN TO FORT SASKATCHEWAN	47755	2			GATE			
NPS 12 FABYAN TO FORT SASKATCHEWAN	47755	3			GATE			
NPS 12 FABYAN TO FORT SASKATCHEWAN	47755	4			UNKNOWN			
NPS 12 FABYAN TO FORT SASKATCHEWAN	47755	5			GATE			
NPS 12 FABYAN TO FORT SASKATCHEWAN	47755	6			GATE			
NPS 12 FABYAN TO FORT SASKATCHEWAN	47755	7			GATE			
NPS 12 FABYAN TO FORT SASKATCHEWAN	47755	7			GATE			
NPS 12 KERROBERT TO FABYAN	47759	7			GATE			
NPS 12 KERROBERT TO FABYAN	47759	7			GATE			
NPS 12 KERROBERT TO FABYAN	47759	8			GATE			
NPS 12 KERROBERT TO FABYAN	47759	9			GATE			
NPS 12 KERROBERT TO FABYAN	47759	10			GATE			
NPS 12 KERROBERT TO FABYAN	47759	11			GATE			
NPS 12 KERROBERT TO FABYAN	47759	11			GATE			
NPS 12 KERROBERT TO FABYAN	47759	12			GATE			
NPS 12 KERROBERT TO FABYAN	47759	13			GATE			
NPS 12 KERROBERT TO FABYAN	47759	14			GATE			
NPS 12 KERROBERT TO FABYAN	47759	14			UNKNOWN			
NPS 12 KERROBERT TO FABYAN	47759	14			GATE			
NPS 12 KERROBERT TO FABYAN	47759	14			GATE			
NPS 12 ELBOW TO KERROBERT	47751	14			GATE			

PRAIRIE SKY DISTRICT, COCHIN (CANADA) PIPELINE SYSTEM

EMERGENCY RESPONSE PLAN

Version Date: August 2023

Version: 4.0

Pipeline Name	Route ID	Map	Valve Name	Valve ID	Valve Type	Location	Latitude (Decimal Degrees)	Longitude (Decimal Degrees)
NPS 12 ELBOW TO KERROBERT	47751	15			GATE			
NPS 12 ELBOW TO KERROBERT	47751	16			GATE			
NPS 12 ELBOW TO KERROBERT	47751	17			GATE			
NPS 12 ELBOW TO KERROBERT	47751	18			GATE			
NPS 12 ELBOW TO KERROBERT	47751	19			GATE			
NPS 12 ELBOW TO KERROBERT	47751	20			GATE			
NPS 12 ELBOW TO KERROBERT	47751	21			GATE			
NPS 12 ELBOW TO KERROBERT	47751	22			GATE			
NPS 12 ESTLIN TO ELBOW	47753	22			GATE			
NPS 12 ESTLIN TO ELBOW	47753	22			GATE			
NPS 12 ESTLIN TO ELBOW	47753	23			GATE			
NPS 12 ESTLIN TO ELBOW	47753	24			GATE			
NPS 12 ESTLIN TO ELBOW	47753	25			UNKNOWN			
NPS 12 ESTLIN TO ELBOW	47753	26			GATE			
NPS 12 ESTLIN TO ELBOW	47753	26			GATE			
NPS 12 ESTLIN TO ELBOW	47753	27			GATE			
NPS 12 ESTLIN TO ELBOW	47753	27			UNKNOWN			
NPS 10 REGINA LATERAL 1	47746	27			UNKNOWN			
NPS 10 REGINA LATERAL 1	47746	27			UNKNOWN			
NPS 10 REGINA LATERAL 1	47746	27			UNKNOWN			
NPS 10 REGINA LATERAL 1	47746	27			UNKNOWN			
NPS 12 ESTLIN TO ELBOW	47753	28			GATE			
NPS 12 ESTLIN TO ELBOW	47753	29			GATE			
NPS 12 ESTLIN TO ELBOW	47753	29			UNKNOWN			
NPS 12 ALAMEDA TO ESTLIN	47748	29			GATE			
NPS 12 ALAMEDA TO ESTLIN	47748	30			GATE			

PRAIRIE SKY DISTRICT, COCHIN (CANADA) PIPELINE SYSTEM
EMERGENCY RESPONSE PLAN
Version Date: August 2023
Version: 4.0

Pipeline Name	Route ID	Map	Valve Name	Valve ID	Valve Type	Location	Latitude (Decimal Degrees)	Longitude (Decimal Degrees)
NPS 12 ALAMEDA TO ESTLIN	47748	31			GATE			
NPS 12 ALAMEDA TO ESTLIN	47748	32			GATE			
NPS 12 ALAMEDA TO ESTLIN	47748	32 & 33			BLOCK			
NPS 12 ALAMEDA TO ESTLIN	47748	33			GATE			
NPS 12 ALAMEDA TO ESTLIN	47748	34 & 35			GATE			
NPS 12 ALAMEDA TO ESTLIN	47748	35			GATE			
NPS 12 ALAMEDA TO ESTLIN	47748	36			BALL			
NPS 12 ALAMEDA TO ESTLIN	47748	36			BLOCK			
NPS 12 ALAMEDA TO ESTLIN	47748	36			BLOCK			
NPS 12 US BORDER TO ALAMEDA	47761	36			GATE			
NPS 12 US BORDER TO ALAMEDA	47761	36			UNKNOWN			
NPS 12 US BORDER TO ALAMEDA	47761	37			GATE			
NPS 12 US BORDER TO ALAMEDA	47761	38			GATE			

6.0 SAFETY EQUIPMENT AND RESOURCES

6.1 Spill Response Equipment

Pembina may respond using a wide variety of equipment depending upon the severity of the event. Additional resources may be obtained from area emergency services, mutual aid partners, third party contractors, or additional Pembina owned equipment caches, depending on the nature of the emergency.

Response equipment within this operating area is located at the following locations:

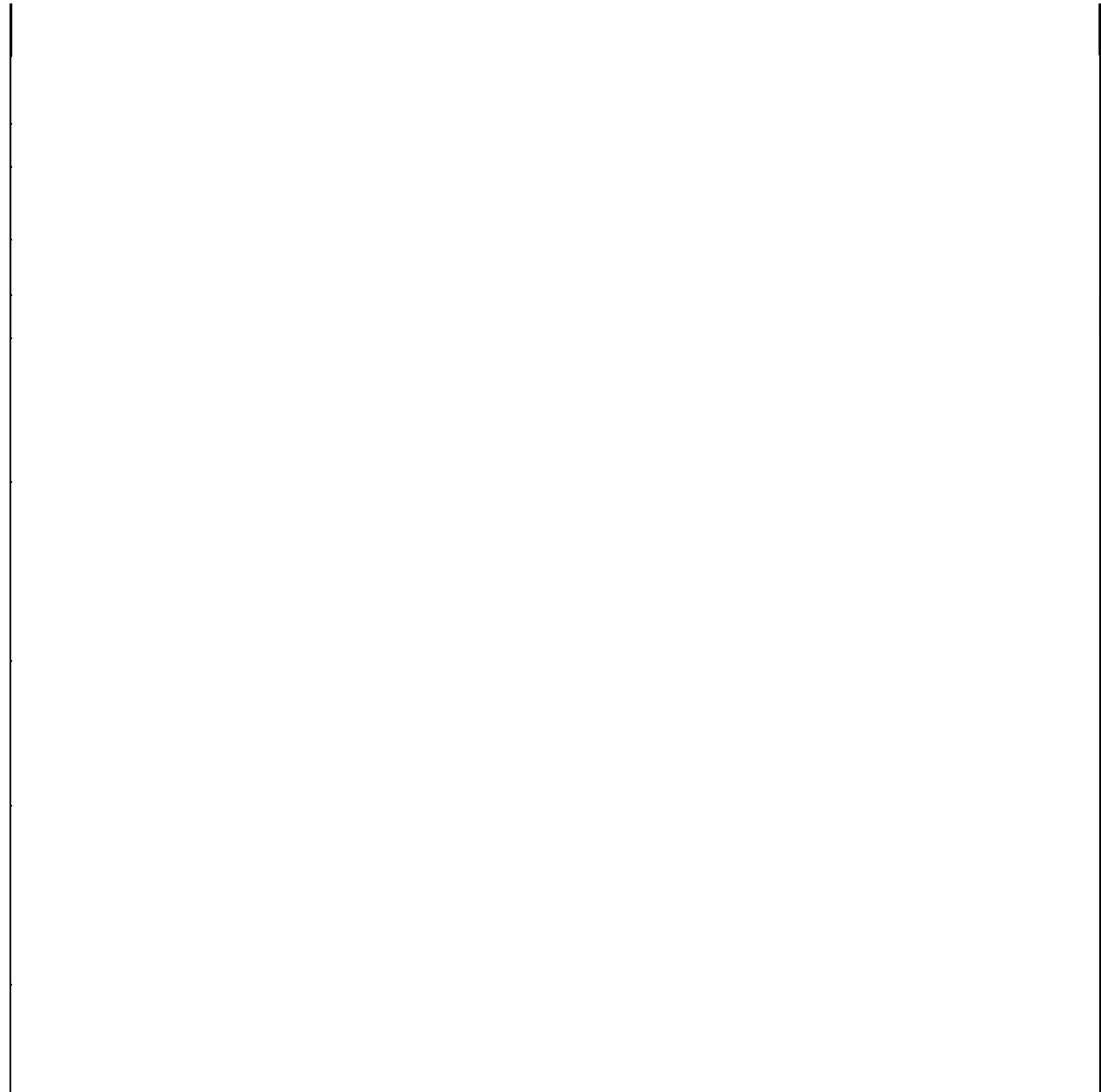

6.2 Personal Protective Equipment (PPE)

The following is a list of personal protective equipment employees and contractors are required to wear, as appropriate:

- Fire-resistant clothing
- Hard hats
- Safety glasses
- Safety boots
- Gloves
- Personal monitor

6.3 Radiation Safety

Contact an authorized or site Radiation Safety Officer (RSO) for further information or documentation related to Pembina's Radiation Safety Program.

6.4 Communications/Radio Frequencies

Landlines at the field office and facilities, cell phones and/or truck radios are regularly used for communications. As required, additional radios and satellite phones will be resourced and used for communications.

In an emergency, confirm the use of any area specific radio channels or special instructions for radio-controlled roads with local personnel.

6.5 Control Points

Control Points are a set of predeveloped response locations and strategies designed to assist the Incident Management Team during the initial phases of a response. The control point data sheets detail the resources and considerations required to implement the suggested response strategy. Control point data sheets are located in the appropriate Spill Control Point Book or on Pembina's intranet site, The Pipeline.

For additional strategies and process that should be considered please see the Corporate Spill Contingency Plan located on Pembina's intranet site, The Pipeline.

7.0 EMERGENCY SYSTEMS AND PROCEDURES

The following site-specific emergency response procedures are in affect along the Cochin (Canada) Pipeline System – Regina Maintenance Zone:

7.1 Incident Onset and Plan Activation

Initial Response Actions and plan activation should occur as set out in the Corporate ERP.

7.2 Incident Notifications / Reporting

Following the onset of an incident, activate the Corporate ERP and follow the Activation Procedure.

7.2.1 Supplemental Notifications

Supplemental notifications and regulatory reporting may be required in the event of a cross-border incident. Refer to the Corporate ERP for information and direction.

7.3 Staging Area(s)

Potential Staging Areas have been identified to deal with spill related emergencies. Refer to the appropriate Spill Control Point Book for the locations of these predetermined areas.

7.4 Emergency Planning Zone (EPZ)

Due to the unique product characteristics of the product, Pembina engaged consultants to assess and recommend an EPZ for the Cochin Pipeline System based on the radiant heat of the initial ignition of a pool of product resulting from a catastrophic release. To calculate the EPZ several assumptions were used including, but not limited to, volume released, size of pool, properties of the product, and radiant heat load. Based on these calculations, an EPZ of 200 meters was adopted.

During an emergency, the EPZ is defined initially on the modeled radius related to the pipeline. Air monitoring results may be used to re-define the area impacted by the incident and to reassign resources to enable Pembina personnel to respond appropriately.

7.5 Response Actions

General hazard specific emergency response actions are included in the *Corporate ERP*, including:

- | | |
|--------------------------------------|---|
| • Operational Failure | Other Emergency: |
| • Product release: Liquids / Gaseous | • Medical Incident |
| • Fire/Explosion | • Motor Vehicle / Transportation Incident |
| • Extreme Weather / Natural Disaster | • Security Incident |

7.5.1 Spill / Product Release

Containment methods (i.e., control points) should be installed ahead of the leading edge of the released fluids to prevent further flow driven product migration allowing time for the product to volatilize and disassociate within the water column. Air monitoring will be required to ensure it is safe for responders to remain at or return to the location.

Cochin (Canada) Pipeline System – Worst Case Discharge (WCD) Scenario

7.6 Unified Command

In the event of an emergency, Pembina will enter Unified Command with emergency services and local authorities who will determine appropriate public protection measures, including requirements for incident notification and communications, and conduct response measures as required. Pembina will support local authorities, as requested.

8.0 STAKEHOLDERS AND MAPS

Pembina conducts regular public involvement efforts to ensure stakeholders are provided with information pertaining to the operations in their area, potential hazards, product characteristics, emergency contact numbers, and the appropriate response actions for them to take in an emergency situation.

Occupant data (resident/business) within the Emergency Planning Zone (EPZ) are each given a unique identifier which corresponds to a land location on a numbered map (refer to the area overview map to determine the map number).

The Dominion Land Survey (DLS) system is used within Alberta, Saskatchewan and portions of western Manitoba and northeast British Columbia. Confidential occupant data within each mapped area is sorted by geographical location; organized by meridian, then township (south to north), then range (east to west), then section, then quarter section and concludes with the unique ID. Example: **NW 31-054-02-W5.A**

5 054 02 31 NW A
 Meridian Township Range Section Quarter Section Unique ID

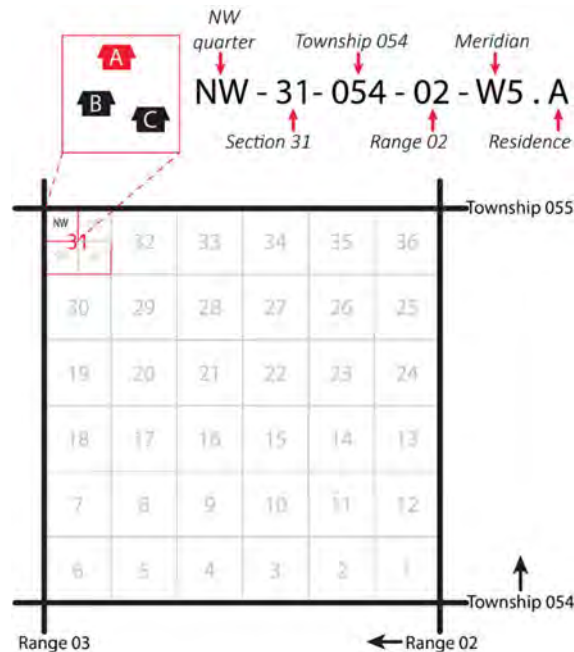

Only select plans will contain occupant data. Refer to the Distribution List for additional details.

This page intentionally left blank.

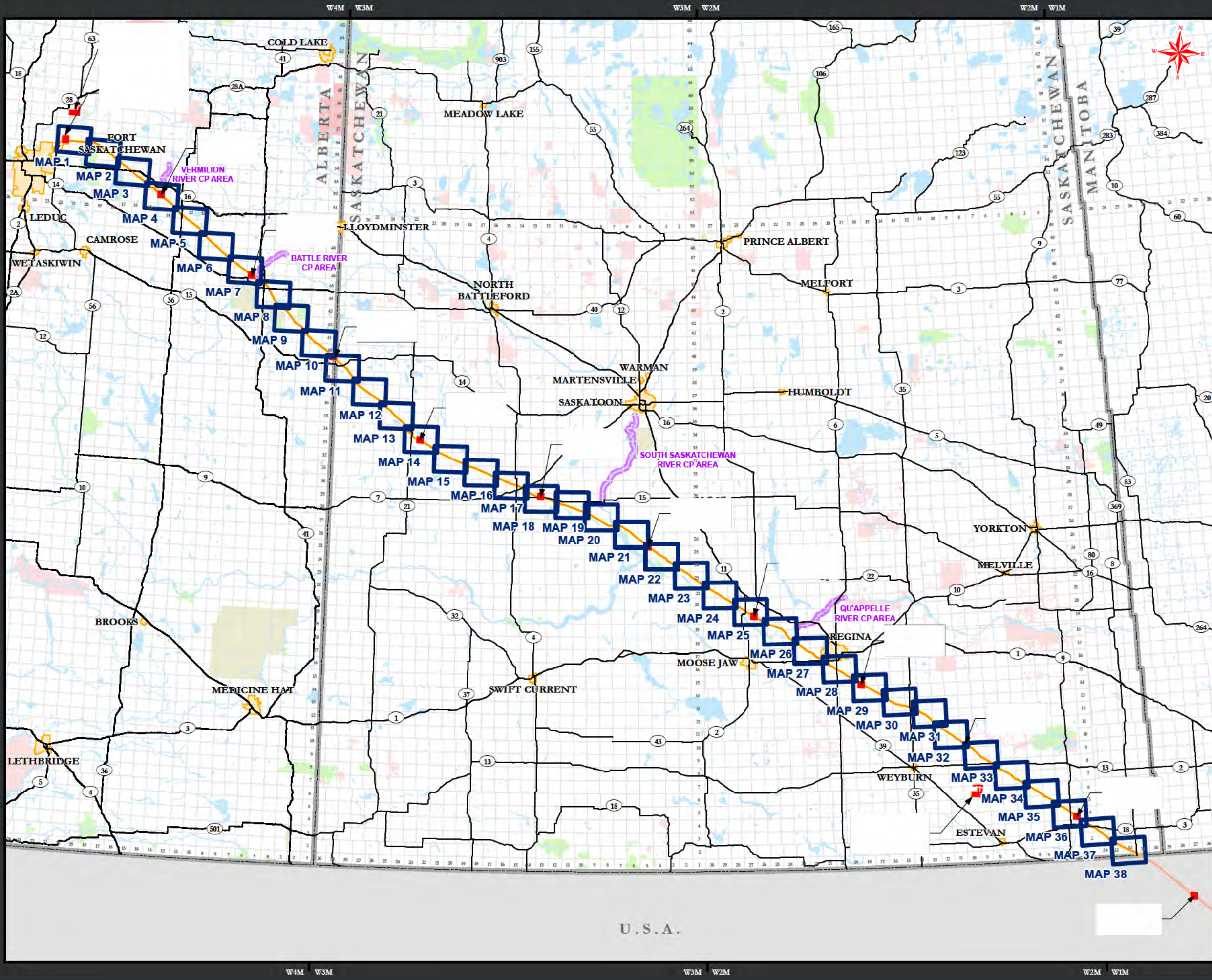

COCHIN CANADA PIPELINE SYSTEM



Draft Date: May 9, 2023 FSC Scale: 1:2,800,000 Map: 14224

Revision Date: August 3, 2023 FSC UTM ZONE 12 NAD83

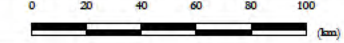

- Facility
- Gas Plant
- Discontinued Oil Pipeline
- LVP Pipeline
- HVP Pipeline
- Misc. Fluids Pipeline
- Discontinued Misc. Fluids Pipeline
- Highway
- Waterbody
- Urban Area
- Protected Area
- First Nations Reserve
- Military Reserve
- Map Boundary
- EPZ
- Additional Control Points Off Mapped Areas

AREA OVERVIEW MAP

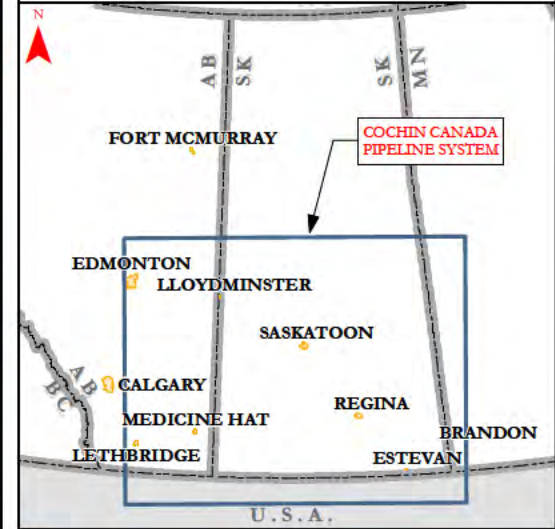
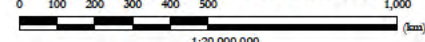

8.2 Cochin (Canada) Pipeline System Maps

Map 1

This mapped area is within the Province of Alberta. The following details apply to the calculated Emergency Planning Zones (EPZs) for this mapped area.

Number of Surface Developments		

Immediate Reporting		
Name	Contact	Phone
For immediate assistance call 911 and provide them with your name and contact details, the type of support you need, and your location.		
Regulator		
Local Authorities		
Health Authorities		

PRAIRIE SKY DISTRICT, COCHIN (CANADA) PIPELINE SYSTEM

EMERGENCY RESPONSE PLAN

Version Date: August 2023

Version: 4.0

Special Area Considerations		
Name	Contact	Phone

School Divisions

Waterbodies

Highways		
Highway	Contact	Phone

Grazing Lease Holders		
Grazing Lease	Contact	Phone

Version: 4.0

Wildlife Management Unit (WMU) Holders		
WMU	Contact	Phone

PRAIRIE SKY DISTRICT, COCHIN (CANADA) PIPELINE SYSTEM

EMERGENCY RESPONSE PLAN

Version Date: August 2023

Version: 4.0

Railways		
Company	Contact	Phone

Industrial Operators		
Company	24-Hour	Phone

Map 2

This mapped area is within the Province of Alberta. The following details apply to the calculated Emergency Planning Zones (EPZs) for this mapped area.

Number of Surface Developments	

Immediate Reporting		
Name	Contact	Phone
For immediate assistance call 911 and provide them with your name and contact details, the type of support you need, and your location.		
Regulator		

Local Authorities

Health Authorities

Special Area Considerations		
Name	Contact	Phone

PRAIRIE SKY DISTRICT, COCHIN (CANADA) PIPELINE SYSTEM

EMERGENCY RESPONSE PLAN

Version Date: August 2023

Version: 4.0

School Divisions

--

Waterbodies

--

Highways

Highway	Contact	Phone

Grazing Lease Holders

Grazing Lease	Contact	Phone

Forestry Management Agreement (FMA) Holders

Name	Contact	Phone

PRAIRIE SKY DISTRICT, COCHIN (CANADA) PIPELINE SYSTEM

EMERGENCY RESPONSE PLAN

Version Date: August 2023

Version: 4.0

Traplines		
Trapline	Contact	Phone

Wildlife Management Unit (WMU) Holders		
WMU	Contact	Phone

Version: 4.0

[illegible]

Map 3

This mapped area is within the Province of Alberta. The following details apply to the calculated Emergency Planning Zones (EPZs) for this mapped area.

Number of Surface Developments		

Immediate Reporting		
Name	Contact	Phone
For immediate assistance call 911 and provide them with your name and contact details, the type of support you need, and your location.		
Regulator		
Local Authorities		
Health Authorities		

Special Area Considerations		
Name	Contact	Phone

PRAIRIE SKY DISTRICT, COCHIN (CANADA) PIPELINE SYSTEM

EMERGENCY RESPONSE PLAN

Version Date: August 2023

Version: 4.0

School Divisions

--

Waterbodies

--

Highways

Highway	Contact	Phone

Grazing Lease Holders

Grazing Lease	Contact	Phone

Forestry Management Agreement (FMA) Holders

Name	Contact	Phone

Version: 4.0

[illegible]

PRAIRIE SKY DISTRICT, COCHIN (CANADA) PIPELINE SYSTEM

EMERGENCY RESPONSE PLAN

Version Date: August 2023

Version: 4.0

Railways		
Company	Contact	Phone

Industrial Operators		
Company	24-Hour	Phone

Map 4

This mapped area is within the Province of Alberta. The following details apply to the calculated Emergency Planning Zones (EPZs) for this mapped area.

Number of Surface Developments		

Immediate Reporting		
Name	Contact	Phone
For immediate assistance call 911 and provide them with your name and contact details, the type of support you need, and your location.		
Regulator		
Local Authorities		
Health Authorities		

Special Area Considerations		
Name	Contact	Phone

PRAIRIE SKY DISTRICT, COCHIN (CANADA) PIPELINE SYSTEM

EMERGENCY RESPONSE PLAN

Version Date: August 2023

Version: 4.0

School Divisions

Waterbodies

Highways		
Highway	Contact	Phone

Grazing Lease Holders		
Grazing Lease	Contact	Phone

Forestry Management Agreement (FMA) Holders		
Name	Contact	Phone

PRAIRIE SKY DISTRICT, COCHIN (CANADA) PIPELINE SYSTEM

EMERGENCY RESPONSE PLAN

Version Date: August 2023

Version: 4.0

Traplines		
Trapline	Contact	Phone

Wildlife Management Unit (WMU) Holders		
WMU	Contact	Phone

Railways		
Company	Contact	Phone

Industrial Operators		
Company	24-Hour	Phone

This page intentionally left blank.

Map 5

This mapped area is within the Province of Alberta. The following details apply to the calculated Emergency Planning Zones (EPZs) for this mapped area.

Number of Surface Developments	

Immediate Reporting		
---------------------	--	--

Name	Contact	Phone
------	---------	-------

For immediate assistance call 911 and provide them with your name and contact details, the type of support you need, and your location.

Regulator

--

Local Authorities

--

Health Authorities

--

Special Area Considerations		
-----------------------------	--	--

Name	Contact	Phone
------	---------	-------

--	--	--

PRAIRIE SKY DISTRICT, COCHIN (CANADA) PIPELINE SYSTEM

EMERGENCY RESPONSE PLAN

Version Date: August 2023

Version: 4.0

School Divisions

--

Waterbodies

--

Highways

Highway	Contact	Phone

Grazing Lease Holders

Grazing Lease	Contact	Phone

Forestry Management Agreement (FMA) Holders

Name	Contact	Phone

PRAIRIE SKY DISTRICT, COCHIN (CANADA) PIPELINE SYSTEM

EMERGENCY RESPONSE PLAN

Version Date: August 2023

Version: 4.0

Traplines		
Trapline	Contact	Phone

Wildlife Management Unit (WMU) Holders		
WMU	Contact	Phone

Railways		
Company	Contact	Phone

Industrial Operators		
Company	24-Hour	Phone

Map 6

This mapped area is within the Province of Alberta. The following details apply to the calculated Emergency Planning Zones (EPZs) for this mapped area.

Number of Surface Developments		

Immediate Reporting		
---------------------	--	--

Name	Contact	Phone
------	---------	-------

For immediate assistance call 911 and provide them with your name and contact details, the type of support you need, and your location.

Regulator

--

Local Authorities

--

Health Authorities

--

Special Area Considerations		
-----------------------------	--	--

Name	Contact	Phone
------	---------	-------

--	--	--

PRAIRIE SKY DISTRICT, COCHIN (CANADA) PIPELINE SYSTEM

EMERGENCY RESPONSE PLAN

Version Date: August 2023

Version: 4.0

School Divisions

Waterbodies

Highways		
Highway	Contact	Phone

Grazing Lease Holders		
Grazing Lease	Contact	Phone

Forestry Management Agreement (FMA) Holders		
Name	Contact	Phone

PRAIRIE SKY DISTRICT, COCHIN (CANADA) PIPELINE SYSTEM

EMERGENCY RESPONSE PLAN

Version Date: August 2023

Version: 4.0

Traplines		
Trapline	Contact	Phone

Wildlife Management Unit (WMU) Holders		
WMU	Contact	Phone

Railways		
Company	Contact	Phone

Industrial Operators		
Company	24-Hour	Phone

This page intentionally left blank.

Map 7

This mapped area is within the Province of Alberta. The following details apply to the calculated Emergency Planning Zones (EPZs) for this mapped area.

Number of Surface Developments	

Immediate Reporting		
Name	Contact	Phone
For immediate assistance call 911 and provide them with your name and contact details, the type of support you need, and your location.		
Regulator		
Local Authorities		
Health Authorities		

Special Area Considerations		
Name	Contact	Phone

PRAIRIE SKY DISTRICT, COCHIN (CANADA) PIPELINE SYSTEM

EMERGENCY RESPONSE PLAN

Version Date: August 2023

Version: 4.0

School Divisions

--

Waterbodies

--

Highways

Highway	Contact	Phone

Grazing Lease Holders

Grazing Lease	Contact	Phone

Forestry Management Agreement (FMA) Holders

Name	Contact	Phone

PRAIRIE SKY DISTRICT, COCHIN (CANADA) PIPELINE SYSTEM

EMERGENCY RESPONSE PLAN

Version Date: August 2023

Version: 4.0

Traplines		
Trapline	Contact	Phone

Wildlife Management Unit (WMU) Holders		
WMU	Contact	Phone

Railways		
Company	Contact	Phone

Industrial Operators		
Company	24-Hour	Phone

This page intentionally left blank.

Map 8

This mapped area is within the Province of Alberta. The following details apply to the calculated Emergency Planning Zones (EPZs) for this mapped area.

Number of Surface Developments	

Immediate Reporting		
Name	Contact	Phone
For immediate assistance call 911 and provide them with your name and contact details, the type of support you need, and your location.		
Regulator		
Local Authorities		
Health Authorities		

Special Area Considerations		
Name	Contact	Phone

PRAIRIE SKY DISTRICT, COCHIN (CANADA) PIPELINE SYSTEM

EMERGENCY RESPONSE PLAN

Version Date: August 2023

Version: 4.0

School Divisions

Waterbodies

Highways		
Highway	Contact	Phone

Grazing Lease Holders		
Grazing Lease	Contact	Phone

Version: 4.0

Wildlife Management Unit (WMU) Holders		
WMU	Contact	Phone

PRAIRIE SKY DISTRICT, COCHIN (CANADA) PIPELINE SYSTEM

EMERGENCY RESPONSE PLAN

Version Date: August 2023

Version: 4.0

Wildlife Management Unit (WMU) Holders		
WMU	Contact	Phone

Railways		
Company	Contact	Phone

Industrial Operators		
Company	24-Hour	Phone

EMERGENCY RESPONSE PLAN

Version Date: August 2023

Version: 4.0

Map 9

This mapped area is within the Province of Alberta. The following details apply to the calculated Emergency Planning Zones (EPZs) for this mapped area.

Number of Surface Developments	

Immediate Reporting		
Name	Contact	Phone
For immediate assistance call 911 and provide them with your name and contact details, the type of support you need, and your location.		
Regulator		
Local Authorities		
Health Authorities		

Special Area Considerations		
Name	Contact	Phone

PRAIRIE SKY DISTRICT, COCHIN (CANADA) PIPELINE SYSTEM

EMERGENCY RESPONSE PLAN

Version Date: August 2023

Version: 4.0

School Divisions

Waterbodies

Highways		
Highway	Contact	Phone

Grazing Lease Holders		
Grazing Lease	Contact	Phone

PRAIRIE SKY DISTRICT, COCHIN (CANADA) PIPELINE SYSTEM

EMERGENCY RESPONSE PLAN

Version Date: August 2023

Version: 4.0

Forestry Management Agreement (FMA) Holders		
Name	Contact	Phone

Traplines		
Trapline	Contact	Phone

Wildlife Management Unit (WMU) Holders		
WMU	Contact	Phone

Railways		
Company	Contact	Phone

Industrial Operators		
Company	24-Hour	Phone

This page intentionally left blank.

Map 10

This mapped area is within the Province of Alberta. The following details apply to the calculated Emergency Planning Zones (EPZs) for this mapped area.

Number of Surface Developments	

Immediate Reporting		
---------------------	--	--

Name	Contact	Phone
------	---------	-------

For immediate assistance call 911 and provide them with your name and contact details, the type of support you need, and your location.

Regulator

--

Local Authorities

--

Health Authorities

--

Special Area Considerations		
-----------------------------	--	--

Name	Contact	Phone
------	---------	-------

--	--	--

PRAIRIE SKY DISTRICT, COCHIN (CANADA) PIPELINE SYSTEM

EMERGENCY RESPONSE PLAN

Version Date: August 2023

Version: 4.0

School Divisions

--

Waterbodies

--

Highways

Highway	Contact	Phone

Grazing Lease Holders

Grazing Lease	Contact	Phone

Forestry Management Agreement (FMA) Holders

Name	Contact	Phone

Version: 4.0

[illegible]

This page intentionally left blank.

Map 11

This mapped area includes both the Province of Alberta and Saskatchewan. The following details apply to the calculated Emergency Planning Zones (EPZs) for this mapped area.

Number of Surface Developments		

Immediate Reporting		
Name	Contact	Phone
For immediate assistance call 911 and provide them with your name and contact details, the type of support you need, and your location.		
Regulator		
Canada Energy Regulator (CER)		for pipeline emergencies 1-819-997-7887
Local Authorities		
Health Authorities		

Special Area Considerations		
Name	Contact	Phone

PRAIRIE SKY DISTRICT, COCHIN (CANADA) PIPELINE SYSTEM

EMERGENCY RESPONSE PLAN

Version Date: August 2023

Version: 4.0

School Divisions

--

Waterbodies

--

Highways

Highway	Contact	Phone

Grazing Lease Holders

Grazing Lease	Contact	Phone

Forestry Management Agreement (FMA) Holders

Name	Contact	Phone

PRAIRIE SKY DISTRICT, COCHIN (CANADA) PIPELINE SYSTEM

EMERGENCY RESPONSE PLAN

Version Date: August 2023

Version: 4.0

Traplines		
Trapline	Contact	Phone

Wildlife Management Unit (WMU) Holders		
WMU	Contact	Phone

Wildlife Management Zone (WMZ) Holders		
WMZ	Contact	Phone

Version: 4.0

[illegible]

Map 12

This mapped area is within the Province of Saskatchewan. The following details apply to the calculated Emergency Planning Zones (EPZs) for this mapped area.

Number of Surface Developments		

Immediate Reporting		
---------------------	--	--

Name	Contact	Phone
------	---------	-------

For immediate assistance call 911 and provide them with your name and contact details, the type of support you need, and your location.

Regulator

--

Local Authorities

--

Health Authorities

--

Special Area Considerations		
-----------------------------	--	--

Name	Contact	Phone
------	---------	-------

--	--	--

PRAIRIE SKY DISTRICT, COCHIN (CANADA) PIPELINE SYSTEM

EMERGENCY RESPONSE PLAN

Version Date: August 2023

Version: 4.0

School Divisions

Waterbodies

Highways		
Highway	Contact	Phone

Grazing Lease Holders		
Grazing Lease	Contact	Phone

Forestry Management Agreement (FMA) Holders		
Name	Contact	Phone

Traplines		
Trapline	Contact	Phone

PRAIRIE SKY DISTRICT, COCHIN (CANADA) PIPELINE SYSTEM

EMERGENCY RESPONSE PLAN

Version Date: August 2023

Version: 4.0

Wildlife Management Zone (WMZ) Holders		
WMZ	Contact	Phone

Railways		
Company	Contact	Phone

Industrial Operators		
Company	24-Hour	Phone

This page intentionally left blank.

Map 13

This mapped area is within the Province of Saskatchewan. The following details apply to the calculated Emergency Planning Zones (EPZs) for this mapped area.

Number of Surface Developments		

Immediate Reporting		
---------------------	--	--

Name	Contact	Phone
------	---------	-------

For immediate assistance call 911 and provide them with your name and contact details, the type of support you need, and your location.

Regulator

--

Local Authorities

--

Health Authorities

--

Special Area Considerations		
-----------------------------	--	--

Name	Contact	Phone
------	---------	-------

--	--	--

PRAIRIE SKY DISTRICT, COCHIN (CANADA) PIPELINE SYSTEM

EMERGENCY RESPONSE PLAN

Version Date: August 2023

Version: 4.0

School Divisions

Waterbodies

Highways		
Highway	Contact	Phone

Grazing Lease Holders		
Grazing Lease	Contact	Phone

Forestry Management Agreement (FMA) Holders		
Name	Contact	Phone

Traplines		
Trapline	Contact	Phone

PRAIRIE SKY DISTRICT, COCHIN (CANADA) PIPELINE SYSTEM

EMERGENCY RESPONSE PLAN

Version Date: August 2023

Version: 4.0

Wildlife Management Zone (WMZ) Holders		
WMZ	Contact	Phone

Railways		
Company	Contact	Phone

Industrial Operators		
Company	24-Hour	Phone

This page intentionally left blank.

Version: 4.0

PRAIRIE SKY DISTRICT, COCHIN (CANADA) PIPELINE SYSTEM

EMERGENCY RESPONSE PLAN

Version Date: August 2023

Version: 4.0

Special Area Considerations		
Name	Contact	Phone

School Divisions

Waterbodies

Highways		
Highway	Contact	Phone

Grazing Lease Holders		
Grazing Lease	Contact	Phone

PRAIRIE SKY DISTRICT, COCHIN (CANADA) PIPELINE SYSTEM

EMERGENCY RESPONSE PLAN

Version Date: August 2023

Version: 4.0

Forestry Management Agreement (FMA) Holders		
Name	Contact	Phone

Traplines		
Trapline	Contact	Phone

Wildlife Management Zone (WMZ) Holders		
WMZ	Contact	Phone

Railways		
Company	Contact	Phone

Industrial Operators		
Company	24-Hour	Phone

EMERGENCY RESPONSE PLAN

Version Date: August 2023

Version: 4.0

[illegible]

Map 15

This mapped area is within the Province of Saskatchewan. The following details apply to the calculated Emergency Planning Zones (EPZs) for this mapped area.

Number of Surface Developments		

Immediate Reporting		
---------------------	--	--

Name	Contact	Phone
------	---------	-------

For immediate assistance call 911 and provide them with your name and contact details, the type of support you need, and your location.

Regulator

--

Local Authorities

--

Health Authorities

--

Special Area Considerations		
-----------------------------	--	--

Name	Contact	Phone
------	---------	-------

--	--	--

PRAIRIE SKY DISTRICT, COCHIN (CANADA) PIPELINE SYSTEM

EMERGENCY RESPONSE PLAN

Version Date: August 2023

Version: 4.0

School Divisions

--

Waterbodies

--

Highways

Highway	Contact	Phone

Grazing Lease Holders

Grazing Lease	Contact	Phone

Forestry Management Agreement (FMA) Holders

Name	Contact	Phone

Traplines

Trapline	Contact	Phone

PRAIRIE SKY DISTRICT, COCHIN (CANADA) PIPELINE SYSTEM

EMERGENCY RESPONSE PLAN

Version Date: August 2023

Version: 4.0

Wildlife Management Zone (WMZ) Holders		
WMZ	Contact	Phone

Railways		
Company	Contact	Phone

Industrial Operators		
Company	24-Hour	Phone

This page intentionally left blank.

Map 16

This mapped area is within the Province of Saskatchewan. The following details apply to the calculated Emergency Planning Zones (EPZs) for this mapped area.

Number of Surface Developments		

Immediate Reporting		
---------------------	--	--

Name	Contact	Phone
------	---------	-------

For immediate assistance call 911 and provide them with your name and contact details, the type of support you need, and your location.

Regulator

--

Local Authorities

--

Health Authorities

--

Special Area Considerations		
-----------------------------	--	--

Name	Contact	Phone
------	---------	-------

--	--	--

PRAIRIE SKY DISTRICT, COCHIN (CANADA) PIPELINE SYSTEM

EMERGENCY RESPONSE PLAN

Version Date: August 2023

Version: 4.0

School Divisions

Waterbodies

Highways		
Highway	Contact	Phone

Grazing Lease Holders		
Grazing Lease	Name	Phone

Forestry Management Agreement (FMA) Holders		
Name	Contact	Phone

Traplines		
Trapline	Contact	Phone

PRAIRIE SKY DISTRICT, COCHIN (CANADA) PIPELINE SYSTEM

EMERGENCY RESPONSE PLAN

Version Date: August 2023

Version: 4.0

Wildlife Management Zone (WMZ) Holders		
WMZ	Contact	Phone

Railways		
Company	Contact	Phone

Industrial Operators		
Company	24-Hour	Phone

This page intentionally left blank.

Map 17

This mapped area is within the Province of Saskatchewan. The following details apply to the calculated Emergency Planning Zones (EPZs) for this mapped area.

Number of Surface Developments		

Immediate Reporting		
---------------------	--	--

Name	Contact	Phone
------	---------	-------

For immediate assistance call 911 and provide them with your name and contact details, the type of support you need, and your location.

Regulator

--

Local Authorities

--

Health Authorities

--

Special Area Considerations		
-----------------------------	--	--

Name	Contact	Phone
------	---------	-------

--	--	--

PRAIRIE SKY DISTRICT, COCHIN (CANADA) PIPELINE SYSTEM

EMERGENCY RESPONSE PLAN

Version Date: August 2023

Version: 4.0

School Divisions

Waterbodies

Highways		
Highway	Contact	Phone

Grazing Lease Holders		
Grazing Lease	Contact	Phone

Forestry Management Agreement (FMA) Holders		
Name	Contact	Phone

Traplines		
Trapline	Contact	Phone

PRAIRIE SKY DISTRICT, COCHIN (CANADA) PIPELINE SYSTEM

EMERGENCY RESPONSE PLAN

Version Date: August 2023

Version: 4.0

Wildlife Management Zone (WMZ) Holders		
WMZ	Contact	Phone

Railways		
Company	Contact	Phone

Industrial Operators		
Company	24-Hour	Phone

This page intentionally left blank.

Map 18

This mapped area is within the Province of Saskatchewan. The following details apply to the calculated Emergency Planning Zones (EPZs) for this mapped area.

Number of Surface Developments

Immediate Reporting

Name	Contact	Phone
------	---------	-------

For immediate assistance call 911 and provide them with your name and contact details, the type of support you need, and your location.

Regulator

--

Local Authorities

--

Health Authorities

--

Special Area Considerations

Name	Contact	Phone
------	---------	-------

--

PRAIRIE SKY DISTRICT, COCHIN (CANADA) PIPELINE SYSTEM

EMERGENCY RESPONSE PLAN

Version Date: August 2023

Version: 4.0

School Divisions

Waterbodies

Highways		
Highway	Contact	Phone

Grazing Lease Holders		
Grazing Lease	Contact	Phone

Forestry Management Agreement (FMA) Holders		
Name	Contact	Phone

Traplines		
Trapline	Contact	Phone

PRAIRIE SKY DISTRICT, COCHIN (CANADA) PIPELINE SYSTEM

EMERGENCY RESPONSE PLAN

Version Date: August 2023

Version: 4.0

Wildlife Management Zone (WMZ) Holders		
WMZ	Contact	Phone

Railways		
Company	Contact	Phone

Industrial Operators		
Company	24-Hour	Phone

This page intentionally left blank.

Map 19

This mapped area is within the Province of Saskatchewan. The following details apply to the calculated Emergency Planning Zones (EPZs) for this mapped area.

Number of Surface Developments	

Immediate Reporting		
Name	Contact	Phone
For immediate assistance call 911 and provide them with your name and contact details, the type of support you need, and your location.		
Regulator		

Local Authorities		

Health Authorities		

Special Area Considerations		
Name	Contact	Phone

PRAIRIE SKY DISTRICT, COCHIN (CANADA) PIPELINE SYSTEM

EMERGENCY RESPONSE PLAN

Version Date: August 2023

Version: 4.0

School Divisions

Waterbodies

Highways		
Highway	Contact	Phone

Grazing Lease Holders		
Grazing Lease	Contact	Phone

Forestry Management Agreement (FMA) Holders		
Name	Contact	Phone

Traplines		
Trapline	Contact	Phone

PRAIRIE SKY DISTRICT, COCHIN (CANADA) PIPELINE SYSTEM

EMERGENCY RESPONSE PLAN

Version Date: August 2023

Version: 4.0

Wildlife Management Zone (WMZ) Holders		
WMZ	Contact	Phone

Railways		
Company	Contact	Phone

Industrial Operators		
Company	24-Hour	Phone

This page intentionally left blank.

Map 20

This mapped area is within the Province of Saskatchewan. The following details apply to the calculated Emergency Planning Zones (EPZs) for this mapped area.

Number of Surface Developments	

Immediate Reporting		
Name	Contact	Phone
For immediate assistance call 911 and provide them with your name and contact details, the type of support you need, and your location.		
Regulator		

Local Authorities

Health Authorities

Special Area Considerations		
Name	Contact	Phone

PRAIRIE SKY DISTRICT, COCHIN (CANADA) PIPELINE SYSTEM

EMERGENCY RESPONSE PLAN

Version Date: August 2023

Version: 4.0

School Divisions

Waterbodies

Highways		
Highway	Contact	Phone

Grazing Lease Holders		
Grazing Lease	Contact	Phone

Forestry Management Agreement (FMA) Holders		
Name	Contact	Phone

Traplines		
Trapline	Contact	Phone

PRAIRIE SKY DISTRICT, COCHIN (CANADA) PIPELINE SYSTEM

EMERGENCY RESPONSE PLAN

Version Date: August 2023

Version: 4.0

Wildlife Management Zone (WMZ) Holders		
WMZ	Contact	Phone

Railways		
Company	Contact	Phone

Industrial Operators		
Company	24-Hour	Phone

This page intentionally left blank.

Map 21

This mapped area is within the Province of Saskatchewan. The following details apply to the calculated Emergency Planning Zones (EPZs) for this mapped area.

Number of Surface Developments		

Immediate Reporting		
Name	Contact	Phone
For immediate assistance call 911 and provide them with your name and contact details, the type of support you need, and your location.		
Regulator		
Local Authorities		
Health Authorities		

Special Area Considerations		
Name	Contact	Phone

PRAIRIE SKY DISTRICT, COCHIN (CANADA) PIPELINE SYSTEM

EMERGENCY RESPONSE PLAN

Version Date: August 2023

Version: 4.0

School Divisions

Waterbodies

Highways		
Highway	Contact	Phone

Grazing Lease Holders		
Grazing Lease	Contact	Phone

Forestry Management Agreement (FMA) Holders		
Name	Contact	Phone

Traplines		
Trapline	Contact	Phone

PRAIRIE SKY DISTRICT, COCHIN (CANADA) PIPELINE SYSTEM

EMERGENCY RESPONSE PLAN

Version Date: August 2023

Version: 4.0

Wildlife Management Zone (WMZ) Holders		
WMZ	Contact	Phone

Railways		
Company	Contact	Phone

Industrial Operators		
Company	24-Hour	Phone

This page intentionally left blank.

Map 22

This mapped area is within the Province of Saskatchewan. The following details apply to the calculated Emergency Planning Zones (EPZs) for this mapped area.

Number of Surface Developments	

Immediate Reporting		
---------------------	--	--

Name	Contact	Phone
------	---------	-------

For immediate assistance call 911 and provide them with your name and contact details, the type of support you need, and your location.

Regulator

--

Local Authorities

--

Health Authorities

--

Special Area Considerations		
-----------------------------	--	--

Name	Contact	Phone
------	---------	-------

--	--	--

PRAIRIE SKY DISTRICT, COCHIN (CANADA) PIPELINE SYSTEM

EMERGENCY RESPONSE PLAN

Version Date: August 2023

Version: 4.0

School Divisions

--

Waterbodies

--

Highways

Highway	Contact	Phone

Grazing Lease Holders

Grazing Lease	Contact	Phone
---------------	---------	-------

--

Forestry Management Agreement (FMA) Holders

Name	Contact	Phone
------	---------	-------

--

PRAIRIE SKY DISTRICT, COCHIN (CANADA) PIPELINE SYSTEM

EMERGENCY RESPONSE PLAN

Version Date: August 2023

Version: 4.0

Traplines		
Trapline	Contact	Phone

Wildlife Management Zone (WMZ) Holders		
WMZ	Contact	Phone

Railways		
Company	Contact	Phone

Industrial Operators		
Company	24-Hour	Phone

This page intentionally left blank.

Map 23

This mapped area is within the Province of Saskatchewan. The following details apply to the calculated Emergency Planning Zones (EPZs) for this mapped area.

Number of Surface Developments		

Immediate Reporting		
Name	Contact	Phone
For immediate assistance call 911 and provide them with your name and contact details, the type of support you need, and your location.		
Regulator		

Local Authorities		
Health Authorities		

Special Area Considerations		
Name	Contact	Phone

PRAIRIE SKY DISTRICT, COCHIN (CANADA) PIPELINE SYSTEM

EMERGENCY RESPONSE PLAN

Version Date: August 2023

Version: 4.0

School Divisions

Waterbodies

Highways		
Highway	Contact	Phone

Grazing Lease Holders		
Grazing Lease	Contact	Phone

Forestry Management Agreement (FMA) Holders		
Name	Contact	Phone

Traplines		
Trapline	Contact	Phone

PRAIRIE SKY DISTRICT, COCHIN (CANADA) PIPELINE SYSTEM

EMERGENCY RESPONSE PLAN

Version Date: August 2023

Version: 4.0

Wildlife Management Zone (WMZ) Holders		
WMZ	Contact	Phone

Railways		
Company	Contact	Phone

Industrial Operators		
Company	24-Hour	Phone

This page intentionally left blank.

Map 24

This mapped area is within the Province of Saskatchewan. The following details apply to the calculated Emergency Planning Zones (EPZs) for this mapped area.

Number of Surface Developments		

Immediate Reporting		
---------------------	--	--

Name	Contact	Phone
------	---------	-------

For immediate assistance call 911 and provide them with your name and contact details, the type of support you need, and your location.

Regulator

--

Local Authorities

--

Health Authorities

--

Special Area Considerations		
-----------------------------	--	--

Name	Contact	Phone
------	---------	-------

--	--	--

PRAIRIE SKY DISTRICT, COCHIN (CANADA) PIPELINE SYSTEM

EMERGENCY RESPONSE PLAN

Version Date: August 2023

Version: 4.0

School Divisions

Waterbodies

Highways		
Highway	Contact	Phone

Grazing Lease Holders		
Grazing Lease	Contact	Phone

Forestry Management Agreement (FMA) Holders		
Name	Contact	Phone

Traplines		
Trapline	Contact	Phone

PRAIRIE SKY DISTRICT, COCHIN (CANADA) PIPELINE SYSTEM

EMERGENCY RESPONSE PLAN

Version Date: August 2023

Version: 4.0

Wildlife Management Zone (WMZ) Holders		
WMZ	Contact	Phone

Railways		
Company	Contact	Phone

Industrial Operators		
Company	24-Hour	Phone

This page intentionally left blank.

Map 25

This mapped area is within the Province of Saskatchewan. The following details apply to the calculated Emergency Planning Zones (EPZs) for this mapped area.

Number of Surface Developments	

Immediate Reporting		
Name	Contact	Phone
For immediate assistance call 911 and provide them with your name and contact details, the type of support you need, and your location.		
Regulator		

Local Authorities

Health Authorities

Special Area Considerations		
Name	Contact	Phone

PRAIRIE SKY DISTRICT, COCHIN (CANADA) PIPELINE SYSTEM

EMERGENCY RESPONSE PLAN

Version Date: August 2023

Version: 4.0

School Divisions

Waterbodies

Highways		
Highway	Contact	Phone

Grazing Lease Holders		
Grazing Lease	Contact	Phone

Forestry Management Agreement (FMA) Holders		
Name	Contact	Phone

Traplines		
Trapline	Contact	Phone

PRAIRIE SKY DISTRICT, COCHIN (CANADA) PIPELINE SYSTEM

EMERGENCY RESPONSE PLAN

Version Date: August 2023

Version: 4.0

Wildlife Management Zone (WMZ) Holders		
WMZ	Contact	Phone

Railways		
Company	Contact	Phone

Industrial Operators		
Company	24-Hour	Phone

This page intentionally left blank.

Map 26

This mapped area is within the Province of Saskatchewan. The following details apply to the calculated Emergency Planning Zones (EPZs) for this mapped area.

Number of Surface Developments

Immediate Reporting		
Name	Contact	Phone
For immediate assistance call 911 and provide them with your name and contact details, the type of support you need, and your location.		
Regulator		

Local Authorities

Health Authorities

Special Area Considerations		
Name	Contact	Phone

PRAIRIE SKY DISTRICT, COCHIN (CANADA) PIPELINE SYSTEM

EMERGENCY RESPONSE PLAN

Version Date: August 2023

Version: 4.0

School Divisions

Waterbodies

Highways		
Highway	Contact	Phone

Grazing Lease Holders		
Grazing Lease	Contact	Phone

Forestry Management Agreement (FMA) Holders		
Name	Contact	Phone

Traplines		
Trapline	Contact	Phone

PRAIRIE SKY DISTRICT, COCHIN (CANADA) PIPELINE SYSTEM

EMERGENCY RESPONSE PLAN

Version Date: August 2023

Version: 4.0

Wildlife Management Zone (WMZ) Holders		
WMZ	Contact	Phone

Railways		
Company	Contact	Phone

Industrial Operators		
Company	24-Hour	Phone

This page intentionally left blank.

Map 27

This mapped area is within the Province of Saskatchewan. The following details apply to the calculated Emergency Planning Zones (EPZs) for this mapped area.

Number of Surface Developments

Immediate Reporting		
---------------------	--	--

Name	Contact	Phone
------	---------	-------

For immediate assistance call 911 and provide them with your name and contact details, the type of support you need, and your location.

Regulator

--

Local Authorities

--

Health Authorities

--

Special Area Considerations		
-----------------------------	--	--

Name	Contact	Phone
------	---------	-------

--	--	--

PRAIRIE SKY DISTRICT, COCHIN (CANADA) PIPELINE SYSTEM

EMERGENCY RESPONSE PLAN

Version Date: August 2023

Version: 4.0

School Divisions

--

Waterbodies

--

Highways

Highway	Contact	Phone

Grazing Lease Holders

Grazing Lease	Contact	Phone

Forestry Management Agreement (FMA) Holders

Name	Contact	Phone

PRAIRIE SKY DISTRICT, COCHIN (CANADA) PIPELINE SYSTEM

EMERGENCY RESPONSE PLAN

Version Date: August 2023

Version: 4.0

Traplines		
Trapline	Contact	Phone

Wildlife Management Zone (WMZ) Holders		
WMZ	Contact	Phone

Railways		
Company	Contact	Phone

Industrial Operators		
Company	24-Hour	Phone

This page intentionally left blank.

Map 28

This mapped area is within the Province of Saskatchewan. The following details apply to the calculated Emergency Planning Zones (EPZs) for this mapped area.

Number of Surface Developments

Immediate Reporting		
---------------------	--	--

Name	Contact	Phone
------	---------	-------

For immediate assistance call 911 and provide them with your name and contact details, the type of support you need, and your location.

Regulator

--

Local Authorities

--

--

Health Authorities

--

Special Area Considerations		
-----------------------------	--	--

Name	Contact	Phone
------	---------	-------

--

PRAIRIE SKY DISTRICT, COCHIN (CANADA) PIPELINE SYSTEM

EMERGENCY RESPONSE PLAN

Version Date: August 2023

Version: 4.0

School Divisions

--

Waterbodies

--

Highways

Highway	Contact	Phone

Grazing Lease Holders

Grazing Lease	Contact	Phone

Forestry Management Agreement (FMA) Holders

Name	Contact	Phone

PRAIRIE SKY DISTRICT, COCHIN (CANADA) PIPELINE SYSTEM

EMERGENCY RESPONSE PLAN

Version Date: August 2023

Version: 4.0

Traplines		
Trapline	Contact	Phone

Wildlife Management Zone (WMZ) Holders		
WMZ	Contact	Phone

Railways		
Company	Contact	Phone

Industrial Operators		
Company	24-Hour	Phone

This page intentionally left blank.

Map 29

This mapped area is within the Province of Saskatchewan. The following details apply to the calculated Emergency Planning Zones (EPZs) for this mapped area.

Number of Surface Developments

Immediate Reporting		
Name	Contact	Phone
For immediate assistance call 911 and provide them with your name and contact details, the type of support you need, and your location.		
Regulator		
Local Authorities		
Health Authorities		

Special Area Considerations		
Name	Contact	Phone

PRAIRIE SKY DISTRICT, COCHIN (CANADA) PIPELINE SYSTEM

EMERGENCY RESPONSE PLAN

Version Date: August 2023

Version: 4.0

School Divisions

Waterbodies

Highways		
Highway	Contact	Phone

Grazing Lease Holders		
Grazing Lease	Contact	Phone

Forestry Management Agreement (FMA) Holders		
Name	Contact	Phone

Traplines		
Trapline	Contact	Phone

PRAIRIE SKY DISTRICT, COCHIN (CANADA) PIPELINE SYSTEM

EMERGENCY RESPONSE PLAN

Version Date: August 2023

Version: 4.0

Wildlife Management Zone (WMZ) Holders		
WMZ	Contact	Phone

Railways		
Company	Contact	Phone

Industrial Operators		
Company	24-Hour	Phone

This page intentionally left blank.

Map 30

This mapped area is within the Province of Saskatchewan. The following details apply to the calculated Emergency Planning Zones (EPZs) for this mapped area.

Number of Surface Developments

Immediate Reporting		
---------------------	--	--

Name	Contact	Phone
------	---------	-------

For immediate assistance call 911 and provide them with your name and contact details, the type of support you need, and your location.

Regulator

--

Local Authorities

--

Health Authorities

--

Special Area Considerations		
-----------------------------	--	--

Name	Contact	Phone
------	---------	-------

--	--	--

PRAIRIE SKY DISTRICT, COCHIN (CANADA) PIPELINE SYSTEM

EMERGENCY RESPONSE PLAN

Version Date: August 2023

Version: 4.0

School Divisions

--

Waterbodies

--

Highways

Highway	Contact	Phone

Grazing Lease Holders

Grazing Lease	Contact	Phone

Forestry Management Agreement (FMA) Holders

Name	Contact	Phone

Traplines

Trapline	Contact	Phone

PRAIRIE SKY DISTRICT, COCHIN (CANADA) PIPELINE SYSTEM

EMERGENCY RESPONSE PLAN

Version Date: August 2023

Version: 4.0

Wildlife Management Zone (WMZ) Holders		
WMZ	Contact	Phone

Railways		
Company	Contact	Phone

Industrial Operators		
Company	24-Hour	Phone

This page intentionally left blank.

Map 31

This mapped area is within the Province of Saskatchewan. The following details apply to the calculated Emergency Planning Zones (EPZs) for this mapped area.

Number of Surface Developments

Immediate Reporting		
---------------------	--	--

Name	Contact	Phone
------	---------	-------

For immediate assistance call 911 and provide them with your name and contact details, the type of support you need, and your location.

Regulator

--

Local Authorities

--

Health Authorities

--

Special Area Considerations		
-----------------------------	--	--

Name	Contact	Phone
------	---------	-------

--	--	--

PRAIRIE SKY DISTRICT, COCHIN (CANADA) PIPELINE SYSTEM

EMERGENCY RESPONSE PLAN

Version Date: August 2023

Version: 4.0

School Divisions

--

Waterbodies

--

Highways

Highway	Contact	Phone

Grazing Lease Holders

Grazing Lease	Contact	Phone

Forestry Management Agreement (FMA) Holders

Name	Contact	Phone

Traplines

Trapline	Contact	Phone

PRAIRIE SKY DISTRICT, COCHIN (CANADA) PIPELINE SYSTEM

EMERGENCY RESPONSE PLAN

Version Date: August 2023

Version: 4.0

Wildlife Management Zone (WMZ) Holders		
WMZ	Contact	Phone

Railways		
Company	Contact	Phone

Industrial Operators		
Company	24-Hour	Phone

This page intentionally left blank.

Map 32

This mapped area is within the Province of Saskatchewan. The following details apply to the calculated Emergency Planning Zones (EPZs) for this mapped area.

Number of Surface Developments

Immediate Reporting		
---------------------	--	--

Name	Contact	Phone
------	---------	-------

For immediate assistance call 911 and provide them with your name and contact details, the type of support you need, and your location.

Regulator

--

Local Authorities

--

Health Authorities

--

Special Area Considerations		
-----------------------------	--	--

Name	Contact	Phone
------	---------	-------

--	--	--

PRAIRIE SKY DISTRICT, COCHIN (CANADA) PIPELINE SYSTEM

EMERGENCY RESPONSE PLAN

Version Date: August 2023

Version: 4.0

School Divisions

Waterbodies

Highways		
Highway	Contact	Phone

Grazing Lease Holders		
Grazing Lease	Contact	Phone

Forestry Management Agreement (FMA) Holders		
Name	Contact	Phone

Traplines		
Trapline	Contact	Phone

PRAIRIE SKY DISTRICT, COCHIN (CANADA) PIPELINE SYSTEM

EMERGENCY RESPONSE PLAN

Version Date: August 2023

Version: 4.0

Wildlife Management Zone (WMZ) Holders		
WMZ	Contact	Phone

Railways		
Company	Contact	Phone

Industrial Operators		
Company	24-Hour	Phone

This page intentionally left blank.

Map 33

This mapped area is within the Province of Saskatchewan. The following details apply to the calculated Emergency Planning Zones (EPZs) for this mapped area.

Number of Surface Developments	

Immediate Reporting		
---------------------	--	--

Name	Contact	Phone
------	---------	-------

For immediate assistance call 911 and provide them with your name and contact details, the type of support you need, and your location.

Regulator

--

Local Authorities

--

Health Authorities

--

PRAIRIE SKY DISTRICT, COCHIN (CANADA) PIPELINE SYSTEM

EMERGENCY RESPONSE PLAN

Version Date: August 2023

Version: 4.0

Special Area Considerations

--

School Divisions

--

Waterbodies

--

Highways

Highway	Contact	Phone

Grazing Lease Holders

Grazing Lease	Contact	Phone

Forestry Management Agreement (FMA) Holders

Name	Contact	Phone

PRAIRIE SKY DISTRICT, COCHIN (CANADA) PIPELINE SYSTEM

EMERGENCY RESPONSE PLAN

Version Date: August 2023

Version: 4.0

Traplines		
Trapline	Contact	Phone

Wildlife Management Zone (WMZ) Holders		
WMZ	Contact	Phone

Railways		
Company	Contact	Phone

Industrial Operators		
Company	24-Hour	Phone

This page intentionally left blank.

Map 34

This mapped area is within the Province of Saskatchewan. The following details apply to the calculated Emergency Planning Zones (EPZs) for this mapped area.

Number of Surface Developments

Immediate Reporting		
---------------------	--	--

Name	Contact	Phone
------	---------	-------

For immediate assistance call 911 and provide them with your name and contact details, the type of support you need, and your location.

Regulator

--

Local Authorities

--

Health Authorities

--

Special Area Considerations		
-----------------------------	--	--

Name	Contact	Phone
------	---------	-------

--	--	--

PRAIRIE SKY DISTRICT, COCHIN (CANADA) PIPELINE SYSTEM

EMERGENCY RESPONSE PLAN

Version Date: August 2023

Version: 4.0

School Divisions

Waterbodies

Highways		
Highway	Contact	Phone

Grazing Lease Holders		
Grazing Lease	Contact	Phone

Forestry Management Agreement (FMA) Holders		
Name	Contact	Phone

Traplines		
Trapline	Contact	Phone

PRAIRIE SKY DISTRICT, COCHIN (CANADA) PIPELINE SYSTEM

EMERGENCY RESPONSE PLAN

Version Date: August 2023

Version: 4.0

Wildlife Management Zone (WMZ) Holders		
WMZ	Contact	Phone

Railways		
Company	Contact	Phone

Industrial Operators		
Company	24-Hour	Phone

This page intentionally left blank.

Map 35

This mapped area is within the Province of Saskatchewan. The following details apply to the calculated Emergency Planning Zones (EPZs) for this mapped area.

Number of Surface Developments

Immediate Reporting		
---------------------	--	--

Name	Contact	Phone
------	---------	-------

For immediate assistance call 911 and provide them with your name and contact details, the type of support you need, and your location.

Regulator

--

Local Authorities

--

Health Authorities

--

Special Area Considerations		
-----------------------------	--	--

Name	Contact	Phone
------	---------	-------

--	--	--

PRAIRIE SKY DISTRICT, COCHIN (CANADA) PIPELINE SYSTEM

EMERGENCY RESPONSE PLAN

Version Date: August 2023

Version: 4.0

School Divisions

Waterbodies

Highways		
Highway	Contact	Phone

Grazing Lease Holders		
Grazing Lease	Contact	Phone

Forestry Management Agreement (FMA) Holders		
Name	Contact	Phone

Traplines		
Trapline	Contact	Phone

PRAIRIE SKY DISTRICT, COCHIN (CANADA) PIPELINE SYSTEM

EMERGENCY RESPONSE PLAN

Version Date: August 2023

Version: 4.0

Wildlife Management Zone (WMZ) Holders		
WMZ	Contact	Phone

Railways		
Company	Contact	Phone

Industrial Operators		
Company	24-Hour	Phone

This page intentionally left blank.

Map 36

This mapped area is within the Province of Saskatchewan. The following details apply to the calculated Emergency Planning Zones (EPZs) for this mapped area.

Number of Surface Developments

Immediate Reporting		
---------------------	--	--

Name	Contact	Phone
------	---------	-------

For immediate assistance call 911 and provide them with your name and contact details, the type of support you need, and your location.

Regulator

--

Local Authorities

--

Health Authorities

--

Special Area Considerations		
-----------------------------	--	--

Name	Contact	Phone
------	---------	-------

--	--	--

PRAIRIE SKY DISTRICT, COCHIN (CANADA) PIPELINE SYSTEM

EMERGENCY RESPONSE PLAN

Version Date: August 2023

Version: 4.0

School Divisions

Waterbodies

Highways		
Highway	Contact	Phone

Grazing Lease Holders		
Grazing Lease	Contact	Phone

Forestry Management Agreement (FMA) Holders		
Name	Contact	Phone

Traplines		
Trapline	Contact	Phone

PRAIRIE SKY DISTRICT, COCHIN (CANADA) PIPELINE SYSTEM

EMERGENCY RESPONSE PLAN

Version Date: August 2023

Version: 4.0

Wildlife Management Zone (WMZ) Holders		
WMZ	Contact	Phone

Railways		
Company	Contact	Phone

Industrial Operators		
Company	24-Hour	Phone

This page intentionally left blank.

Map 37

This mapped area is within the Province of Saskatchewan. The following details apply to the calculated Emergency Planning Zones (EPZs) for this mapped area.

Number of Surface Developments

Immediate Reporting		
Name	Contact	Phone
For immediate assistance call 911 and provide them with your name and contact details, the type of support you need, and your location.		
Regulator		

Local Authorities

Health Authorities

Special Area Considerations		
Name	Contact	Phone

PRAIRIE SKY DISTRICT, COCHIN (CANADA) PIPELINE SYSTEM

EMERGENCY RESPONSE PLAN

Version Date: August 2023

Version: 4.0

School Divisions

Waterbodies

Highways		
Highway	Contact	Phone

Grazing Lease Holders		
Grazing Lease	Contact	Phone

Forestry Management Agreement (FMA) Holders		
Name	Contact	Phone

Traplines		
Trapline	Contact	Phone

PRAIRIE SKY DISTRICT, COCHIN (CANADA) PIPELINE SYSTEM

EMERGENCY RESPONSE PLAN

Version Date: August 2023

Version: 4.0

Wildlife Management Zone (WMZ) Holders		
WMZ	Contact	Phone

Railways		
Company	Contact	Phone

Industrial Operators		
Company	24-Hour	Phone

This page intentionally left blank.

Map 38

This mapped area is within the Province of Saskatchewan. The following details apply to the calculated Emergency Planning Zones (EPZs) for this mapped area.

The Cochin (Canada) Pipeline and Prairie Sky District terminate at the Canada / United States border. For detailed information about Cochin Pipeline operations, assets and associated emergency response actions within the United States, refer to Cochin (US) Pipeline District Emergency Response Plan.

Number of Surface Developments	

Immediate Reporting		
---------------------	--	--

Name	Contact	Phone
------	---------	-------

For immediate assistance call 911 and provide them with your name and contact details, the type of support you need, and your location.

Regulator

--

Local Authorities

--

Health Authorities

--

Special Area Considerations		
-----------------------------	--	--

Name	Contact	Phone
------	---------	-------

--	--	--

PRAIRIE SKY DISTRICT, COCHIN (CANADA) PIPELINE SYSTEM

EMERGENCY RESPONSE PLAN

Version Date: August 2023

Version: 4.0

School Divisions

Waterbodies

Highways		
Highway	Contact	Phone

Grazing Lease Holders		
Grazing Lease	Contact	Phone

Forestry Management Agreement (FMA) Holders		
Name	Contact	Phone

Traplines		
Trapline	Contact	Phone

Version: 4.0

[illegible]

This page intentionally left blank.